



CROMSON

Expertise · Quality · Innovation



HAND TOOLS

ABRASIVES

CUTTING TOOLS

MAINTENANCE

MATERIAL HANDLING

SAFETY

INDUSTRIAL SUPPLIES

cromson.com



THE BEGINNING

Among them:

Angélique
18 years of experience
Crom's Coordinator

Léonard
13 years of experience
Cromson Captain

Christophe
30 years of experience
Chief, Visionary leader

André
40 years of experience
Master, quiet strength

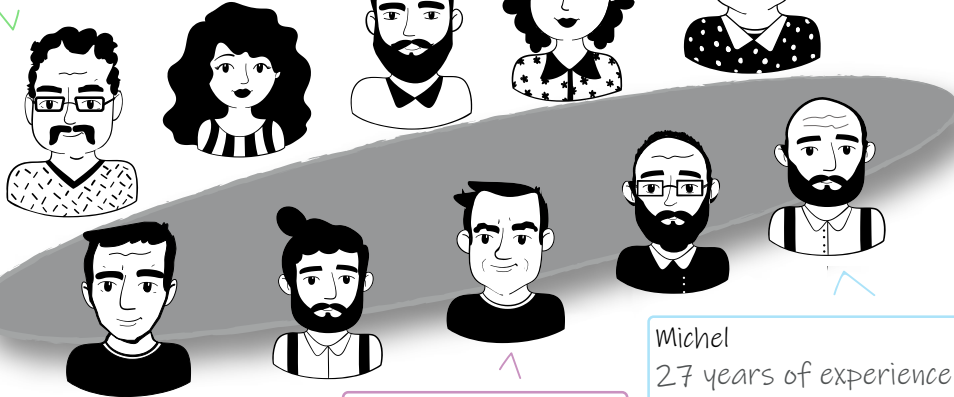

Robert
40 years of experience
Cutting Tools Pro

Marc
30 years of experience
Communications Genius

Michel
27 years of experience
Tool God

FAMILY VALUES
RESPECT
PASSION
EFFICIENCY
COLLABORATION



AMBITION
AND KNOW HOW



CONSOLIDATION
OF PASSIONATE
PEOPLE

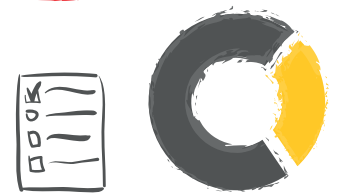

ANALYSIS



NORTH AMERICAN
MARKET RESEARCH

MEETING WITH
INTERNATIONAL
MANUFACTURERS



ATTENDING
INTERNATIONAL
TRADE SHOWS

COMPARATIVE
REAL-WORLD
TESTING



CONSULTATION WITH
KEY CUSTOMERS



MULTIPLE
ROUND TABLES

BRAINSTORMING



EXPERTISE



CROMSON'S STORY...

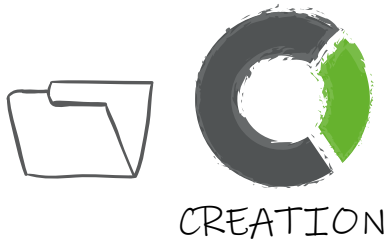

CREATION

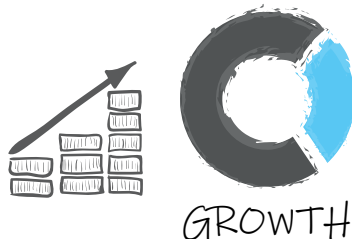

GROWTH



TODAY

BRAND DESIGN 

 2012 BEGINNING

2014 ANALYSIS

CANADA



NORTH AMERICAN
AND EUROPEAN
MANUFACTURING



MEDIAS

PRESENTATION AND
CUSTOMER TESTING

PARTICIPATIVE BRAND



 2016 LAUNCH
• TOOLS
• ABRASIVES

2018 CUTTING TOOLS
 • TOOLS-EXPANDED
OFFERING
• MATERIAL
HANDLING

2019 FOAM MADE-
TO-MEASURE

 • EASYCLICK
COMPOSITE
RATCHET

 • MAINTENANCE
• SAFETY

↓
MAKE
INNOVATION
ACCESSIBLE

 ONLINE
AVAILABILITY

industrial-supplies.ca

QUICK
DELIVERY

24H
•
48H

AVAILABLE AT
+ 15 COMPANIES



CROMSON
ACTIVELY SUPPORTS
LOCAL AND
INTERNATIONAL
GOODWILL
ORGANIZATIONS

CROMSON, A
TRUSTWORTHY
BRAND



QUALITY

INNOVATION



CROMSON is a trustworthy brand that wishes its growth will leave a positive impact through its values.

 CROMSON, a series of technical and superior qualities:

- Partnership with industry-leading manufacturers primarily in North America and Europe.
- Product selection based on the client's essential needs.
- Available at every local distributor, closest to the client.

Therefore, minimizing the carbon footprint throughout our supply and distribution chain.

CROMSON actively supports local and international associations by devoting a portion of its sales profits to help support these organizations.

By using and buying CROMSON products, you are actively taking part in helping our community.

 On an international level, CROMSON supports the EPIC Foundation. Created by philanthropist Alexandre Mars, this foundation gives 100% of the funds it collects back to associations that have been audited and evaluated.



 Locally, CROMSON supports associations that work to encourage academic success in its communities.



Product Index



P. 6



P. 48



P. 58



P. 70



P. 82



P. 90



P. 100

LIFETIME WARRANTY

CROMSON tools come with a lifetime warranty except for the products listed below:

- ABS and ALU storage boxes
- Storage box CR4001
- Storage case ETC14
- Storage foam CR2800
- Non-warranty items: abrasives, maintenance, cutting tools, material handling and safety products



CROMSON will exchange any defective products used under normal conditions and according to its intended use.

CROMSON ensures that its products are manufactured according to industry standards and that each of them is guaranteed against manufacturing defects during its lifetime*.

CONDITIONS OF APPLICATION OF THE WARRANTY

This warranty applies only to new CROMSON products purchased from a CROMSON distributor.

Product with signs of misuse, tampering, abnormal wear and tear, abnormal use, modifications or that haven't been maintained properly will be excluded from the warranty.

For a set, the warranty is the one associated with the retail products it contains.

In the case of a product that has been discontinued, CROMSON reserves the right to offer a product that is technically equivalent or superior depending on the product's development.

The warranty is limited to defective parts.

CROMSON cannot be held responsible for any damages related to its products.

TERMS OF USE FOR THE WARRANTY

Any claim made under the warranty must be accompanied by proof of purchase from the customer.

Defective products must be returned through the original distributor.

The products are appraised by our technical services who then decide how the warranty will be applied.

* Product used for the intended application.

LEGEND



ALUMINUM



STAINLESS STEEL



WOOD



STEEL



CONCRETE



Excellent grip on damaged parts
Increased surface contact
Reduced corner rounding
Contacts the fastener on the flats not on the corners



Additional Information



Precise return springs to reduce the risk of muscle injury



HAND TOOLS

ONE MOTTO AND A SINGLE GOAL:
PERFORMANCE AND EASE OF USE.



EXPERTISE

Products researched and designed for professional use that meet or exceed industry standards



QUALITY

A selection of performance-oriented materials offering the best value for the money



INNOVATION

A range combining comfort, durability and toughness

1/4" TOOLS



1/4" drive Ratchet - 72 teeth

Chrome vanadium steel
Standards : ISO 3315

Resistant and precise ratchet for use in all types of environments

Quick and convenient one-handed rotation change using the reversing ring

Ergonomic and comfortable composite handle that ensures a solid grip

Precise, it allows working in reduced spaces thanks to its compact head and low angle of displacement

Part Number	Size	Length
CR2000	1/4"	140 mm - 5-1/4"

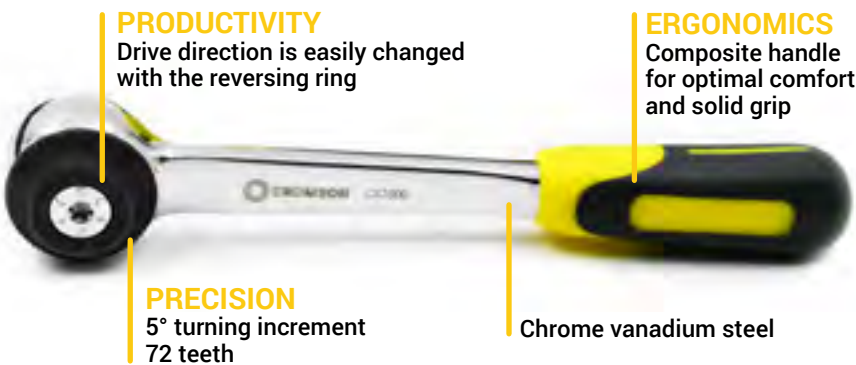

Accessories 1/4"

Chrome vanadium steel
Standards: ISO 3316-1174/1
Polished chromed finish

Product name	Part Number	Size	Length
Extension	CR2001	1/4"	100 mm - 4"
Extension	CR2002	1/4"	50 mm - 2"
Universal joint	CR2003	1/4"	38 mm - 1-1/2"



U-joint's angle allows easier access for hard to reach fasteners

6-point metric sockets, 1/4" drive

Chrome vanadium steel
Standards: ISO 691/1711 - 1/1174 - 1/2725 - 1/3315
Polished chrome finish



SO EASY profile : safer for the fastener and more powerful.



Part Number	Size	Height (H)
CR1000	4 mm	25 mm
CR1001	5 mm	25 mm
CR1002	5.5 mm	25 mm
CR1003	6 mm	25 mm
CR1004	7 mm	25 mm
CR1005	8 mm	25 mm
CR1006	9 mm	25 mm
CR1007	10 mm	25 mm
CR1008	11 mm	25 mm
CR1009	12 mm	25 mm
CR1010	13 mm	25 mm
CR1011	14 mm	25 mm

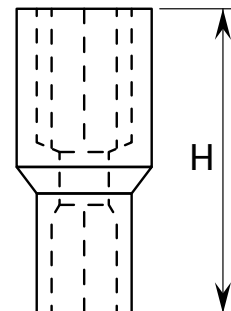

6-point SAE sockets, 1/4" drive

Chrome vanadium steel
Standards: ISO 691/1711 - 1/1174 - 1/2725 - 1/3315
Polished chrome finish



SO EASY profile : safer for the fastener and more powerful.



Part Number	Size	Height (H)
CR1500	3/16"	31/32"
CR1501	7/32"	31/32"
CR1502	1/4"	31/32"
CR1503	9/32"	31/32"
CR1504	5/16"	31/32"
CR1505	11/32"	31/32"
CR1506	3/8"	31/32"
CR1507	13/32"	31/32"
CR1508	7/16"	31/32"
CR1509	1/2"	31/32"
CR1510	9/16"	31/32"

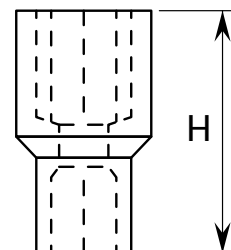

1/4" drive bit-holder screwdriver

Chrome vanadium steel
Standards: ISO 3315 - 1174/1

Ergonomic tool with many available accessories for every job

Part Number	Length
CR4002	6"









1/4" drive bit-holder socket

Chrome vanadium steel
Standards: ISO 1174/1 - DIN 3120

Part Number	Length
CR2004	15/16"



Set of 30 bits and bit-holder

-  Square
-  Slotted
-  Hexagonal
-  TORX®
-  Phillips®
-  Pozidriv®

Hardened steel bits
Plastic box

Standards: ISO 1173/2351 - 3/2351-3, DIN 3126/3127-1

Contents:
1 Bit holder
5 SLOTTED bits (SL): 3.5, 4.5, 5.5, 6.5, 8
9 TORX bits (T): 8, 9, 10, 15, 20, 25, 27, 30, 40
3 PHILLIPS bits (PH): 1, 2, 3
3 POZIDRIV bits (PZ): 1, 2, 3
7 HEXAGONAL bits (HEX): 2, 3, 4, 5, 6, 7, 8
3 SQUARE bits (SQ): 1, 2, 3

Storage box included
Handy belt clip for easy access

Part Number	CR4001
-------------	--------



3/8" TOOLS



3/8" drive Composite Ratchet EASYCLICK - 72 teeth

Standards: NF ISO 1174-1

Resistant and precise ratchet for use in all types of environments

72 tooth ratchet with 5° turning increments

Features a reversing lever for easy one-handed use

Composite body, 15% lighter than a classic ratchet

Scratch-resistant matte finish

Easy to use and simple maintenance

Hole in handle for easy storage



Part Number	Size	Length
CR2100	3/8"	200 mm - 8"

PRODUCTIVITY

Time saving **PRESS** System, push button quick socket release

Reverse lever with one finger

PRECISION

5° turning increment
Ideal when space is limited
72 teeth



Composite handle

ERGONOMICS

15% lighter than a classic ratchet
Scratch-resistant matte finish

Accessories 3/8"

Chrome vanadium steel

Standards: ISO 3316-1174/1

Polished chromed finish

Product name	Part Number	Size	Length
Extension	CR2103	3/8"	75 mm - 3"
Extension	CR2106	3/8"	150 mm - 6"
Universal joint	CR2105	3/8"	55 mm - 2-3/16"



U-joint's angle allows easier access for hard to reach fasteners

6-point metric sockets, 3/8" drive

Chrome vanadium steel
Standards: ISO 1173 - ISO 1174-1
Polished chrome finish



SO EASY profile : safer for the fastener and more powerful



Part Number	Size	Height (H)
CR1034	6 mm	28 mm
CR1035	7 mm	28 mm
CR1036	8 mm	28 mm
CR1037	9 mm	28 mm
CR1038	10 mm	28 mm
CR1039	11 mm	28 mm
CR1040	12 mm	28 mm
CR1041	13 mm	28 mm
CR1042	14 mm	28 mm
CR1043	15 mm	28 mm
CR1044	16 mm	28 mm
CR1045	17 mm	30 mm
CR1046	18 mm	30 mm
CR1047	19 mm	30 mm
CR1048	20 mm	30 mm
CR1049	21 mm	30 mm
CR1050	22 mm	30 mm
CR1051	24 mm	30 mm

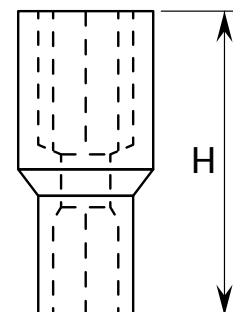

6-point SAE sockets, 3/8" drive

Chrome vanadium steel
Standards: ISO 1173 - ISO 1174-1
Polished chrome finish



SO EASY profile : safer for the fastener and more powerful



Part Number	Size	Height (H)
CR1525	1/4"	1"
CR1526	5/16"	1"
CR1527	3/8"	1-1/4"
CR1528	7/16"	1-1/4"
CR1529	1/2"	1-1/4"
CR1530	9/16"	1-1/4"
CR1531	5/8"	1-1/4"
CR1532	11/16"	1-1/2"
CR1533	3/4"	1-1/2"

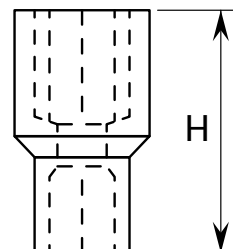

6-point deep metric sockets, 3/8" drive

Chrome vanadium steel
Standards: ISO 3316 - ISO 1174-1
Polished chrome finish



SO EASY profile : safer for the fastener and more powerful

Part Number	Size	Height (H)
CR1615	8 mm	64 mm
CR1616	9 mm	64 mm
CR1617	10 mm	64 mm
CR1618	11 mm	64 mm
CR1619	12 mm	64 mm
CR1620	13 mm	64 mm
CR1621	14 mm	64 mm
CR1622	15 mm	64 mm
CR1623	16 mm	64 mm
CR1624	17 mm	64 mm
CR1625	18 mm	64 mm
CR1626	19 mm	64 mm
CR1627	21 mm	64 mm

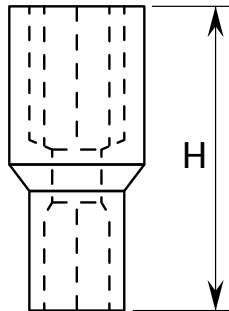

6-point deep SAE sockets, 3/8" drive

Chrome vanadium steel
Standards: ISO 3316 - ISO 1174-1
Polished chrome finish



SO EASY profile : safer for the fastener and more powerful

Part Number	Size	Height (H)
CR1813	3/8"	2-1/2"
CR1814	7/16"	2-1/2"
CR1815	1/2"	2-1/2"
CR1816	9/16"	2-1/2"
CR1817	5/8"	2-1/2"
CR1818	11/16"	2-1/2"
CR1819	3/4"	2-1/2"
CR1820	13/16"	2-1/2"
CR1821	7/8"	2-1/2"

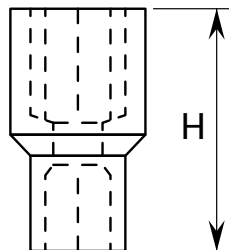

1/2" TOOLS



1/2" drive Ratchet - 72 teeth

Chrome vanadium steel
Standards : ISO 3315

Resistant and precise ratchet for use in all types of environments

Quick and convenient one-handed rotation change using the reversing ring

Ergonomic and comfortable composite handle that ensures a solid grip

Precise, it allows working in reduced spaces thanks to its compact head and low angle of displacement

Part Number	Size	Length
CR2005	1/2"	250 mm - 10"

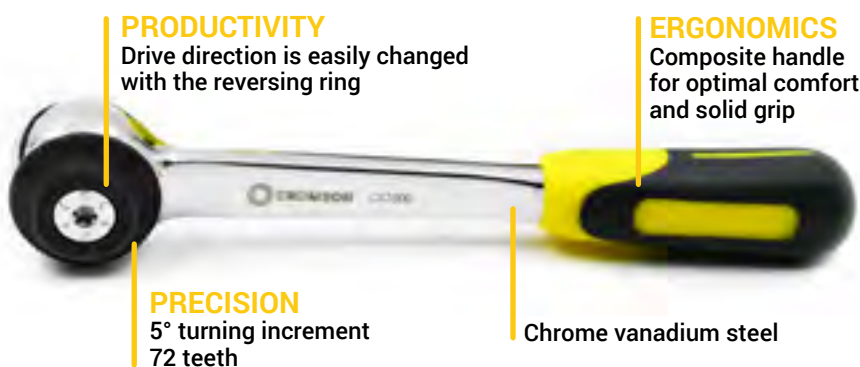

Accessories 1/2"

Chrome vanadium steel
Standards: ISO 3316-1174/1
Polished chromed finish

Product name	Part Number	Size	Length
Extension	CR2006	1/2"	250 mm - 10"
Extension	CR2007	1/2"	125 mm - 5"
Universal joint	CR2008	1/2"	72 mm - 3"



U-joint's angle allows easier access for hard to reach fasteners

6-point metric sockets, 1/2" drive

Chrome vanadium steel
Standards: ISO 691/1711 - 1/1174 - 1/2725 - 1/3315
Polished chrome finish



SO EASY profile : safer for the fastener and more powerful



Part Number	Size	Height (H)
CR1012	10 mm	38 mm
CR1013	11 mm	38 mm
CR1014	12 mm	38 mm
CR1015	13 mm	38 mm
CR1016	14 mm	38 mm
CR1017	15 mm	38 mm
CR1018	16 mm	38 mm
CR1019	17 mm	38 mm
CR1020	18 mm	38 mm
CR1021	19 mm	38 mm
CR1022	20 mm	38 mm
CR1023	21 mm	38 mm
CR1024	22 mm	38 mm
CR1025	24 mm	38 mm
CR1026	25 mm	38 mm
CR1027	26 mm	40 mm
CR1028	27 mm	40 mm
CR1029	28 mm	40 mm
CR1030	29 mm	40 mm
CR1031	30 mm	42 mm
CR1032	31 mm	42 mm
CR1033	32 mm	42 mm

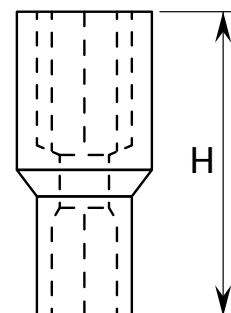

6-point SAE sockets, 1/2" drive

Chrome vanadium steel
Standards: ISO 691/1711 - 1/1174 - 1/2725 - 1/3315
Polished chrome finish



SO EASY profile : safer for the fastener and more powerful



Part Number	Size	Height (H)
CR1511	3/8"	1-1/2"
CR1512	7/16"	1-1/2"
CR1513	1/2"	1-1/2"
CR1514	9/16"	1-1/2"
CR1515	5/8"	1-1/2"
CR1516	11/16"	1-1/2"
CR1517	3/4"	1-1/2"
CR1518	13/16"	1-1/2"
CR1519	7/8"	1-1/2"
CR1520	15/16"	1-1/2"
CR1521	1"	1-9/16"
CR1522	1-1/16"	1-21/32"
CR1523	1-1/8"	1-11/16"
CR1524	1-1/4"	1-23/32"

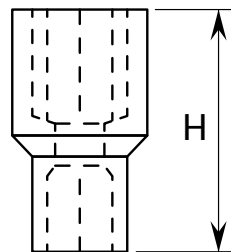

6-point deep metric sockets, 1/2" drive

Chrome vanadium steel
Standards: ISO 3316 - ISO 1174-1
Polished chrome finish



SO EASY profile : safer for the fastener and more powerful

Part Number	Size	Height (H)
CR1600	10 mm	77 mm
CR1601	12 mm	77 mm
CR1602	13 mm	77 mm
CR1603	14 mm	77 mm
CR1604	15 mm	77 mm
CR1605	16 mm	77 mm
CR1606	17 mm	77 mm
CR1607	18 mm	77 mm
CR1608	19 mm	77 mm
CR1609	20 mm	77 mm
CR1610	21 mm	77 mm
CR1611	22 mm	77 mm
CR1612	23 mm	77 mm
CR1613	24 mm	77 mm
CR1614	27 mm	77 mm

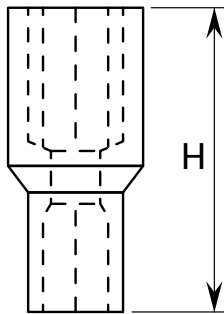

6-point deep SAE sockets, 1/2" drive

Chrome vanadium steel
Standards: ISO 3316 - ISO 1174-1
Polished chrome finish



SO EASY profile : safer for the fastener and more powerful

Part Number	Size	Height (H)
CR1800	7/16"	3-1/32"
CR1801	1/2"	3-1/32"
CR1802	9/16"	3-1/32"
CR1803	5/8"	3-1/32"
CR1804	11/16"	3-1/32"
CR1805	3/4"	3-1/32"
CR1806	13/16"	3-1/32"
CR1807	7/8"	3-1/32"
CR1808	15/16"	3-1/32"
CR1809	1"	3-1/32"
CR1810	1-1/16"	3-1/32"
CR1811	1-1/8"	3-1/32"
CR1812	1-1/4"	3-1/32"

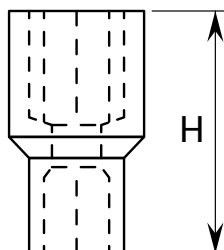



10 PC. SCREWDRIVER SET

Part Number : CR2800

- Ergonomic
- Rugged
- Multifunction perforated handle
- Chrome vanadium steel blade
- Easily identifiable
- Strong grip
- 25% more torque transfer





STORAGE SOLUTION

Tool organizer made from "SELECT" firm foam, included with 10-pc. set.

SLOTTED



SL 1/4 x 4"
SL 5/16 x 6"
SL 3/8 x 10"
SL 3/8 x 12"

PHILLIPS



PH 1 x 4"
PH 2 x 5"
PH 3 x 6"

SQUARE

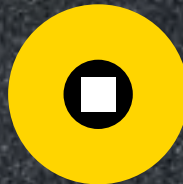

SQ 1 x 3"
SQ 2 x 4"
SQ 3 x 6"



Size of the organizer foam

Width : 18"
Depth : 12"
Height : 1-3/4"

Stores directly
into tool chest drawers
and roller cabinets



All our screwdrivers are equipped with an ergonomic handle and a chrome vanadium steel blade

- Effortless tightening of fasteners
- Shock resistant for durable performance
- Multifunction perforated handle
- Easily identifiable
- 25% more torque transfer

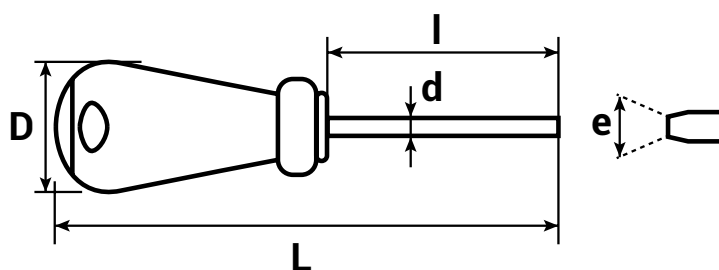

Slotted screwdrivers



Part Number	e x l (in)	l (mm)	d (mm)	D (mm)	L (mm)
CR2504	SL 1/4 x 4"	102	6	34	215
CR2506	SL 5/16 x 6"	152	8	38	277
CR2510	SL 3/8 x 10"	250	10	38	375
CR2512	SL 3/8 x 12"	300	10	38	425

Phillips screwdrivers



Part Number	e x l (in)	l (mm)	d (mm)	D (mm)	L (mm)
CR2603	PH 1 x 3"	76	5	32	179
CR2604	PH 2 x 4"	102	6	34	215
CR2606	PH 3 x 6"	152	8	34	215

Square screwdrivers



Part Number	e x l (in)	l (mm)	d (mm)	D (mm)	L (mm)
CR2704	SQ 1 x 4"	102	5	32	227
CR2705	SQ 2 x 5"	127	6	34	240
CR2706	SQ 3 x 6"	152	8	38	278



Plus : Removable and reversible stainless steel shaft to be used as 1/4" or 5/16" nut driver

CROMSON Super 8 Plus Screwdriver PICQUIC

Comes with 7 hex bits and two nut drivers

3" long bits precision machined and hardened to withstand years of use

Hexagon alloy handle that adapts to a 7/16" wrench to help loosen stubborn screws

Powerful magnet to hold bits in the handle

Solid handle for maximum comfort and torque

Meets all needs

Part Number : CR2900



Plus : 5/16" 1/4"



- Performance
- Durability
- Powerful



12-point metric combination wrenches



Chrome vanadium steel
Standards: ISO 691/1711-1/3318/691/7738

SO EASY profile : rugged and safer for the fastener



Part Number	Size
CR3000	9 mm
CR3001	10 mm
CR3002	11 mm
CR3003	12 mm
CR3004	13 mm
CR3005	14 mm
CR3006	15 mm
CR3007	16 mm
CR3008	17 mm
CR3009	18 mm
CR3010	19 mm
CR3011	20 mm
CR3012	21 mm
CR3013	22 mm
CR3014	23 mm
CR3015	24 mm
CR3016	25 mm
CR3017	26 mm
CR3018	27 mm
CR3019	28 mm
CR3020	29 mm
CR3021	30 mm
CR3022	32 mm

12-point SAE combination wrenches



Chrome vanadium steel
Standards: ISO 691/1711-1/3318/691/7738

SO EASY profile : rugged and safer for the fastener



Part Number	Size
CR3500	3/8"
CR3501	7/16"
CR3502	1/2"
CR3503	9/16"
CR3504	5/8"
CR3505	11/16"
CR3506	3/4"
CR3507	13/16"
CR3508	7/8"
CR3509	15/16"
CR3510	1"
CR3511	1-1/16"
CR3512	1-1/8"
CR3513	1-1/4"

Storage pouch for 14 combination wrenches

Long-lasting and waterproof

14 storage locations with tie-string to store and organize your tools

Eyelets for easy wall hanging

Easy to carry and clean

Part Number ETC14



i BUILD YOUR OWN SET WITH OUR WRENCHES ON PAGE 24



Set of 14 12-point combination wrenches - Metric or SAE

Set of 14 combination wrenches with storage pouch

Long-lasting and waterproof

14 storage locations with cord to store and organize your tools

Eyelets for easy wall hanging

Easy to carry and clean

Part Number	Unit
<u>ETI1400</u>	SAE
3/8, 7/16, 1/2, 9/16, 5/8, 11/16, 3/4, 13/16, 7/8, 15/16, 1, 1-1/16, 1-1/8, 1-1/4"	

Part Number	Metric
<u>ETM1400</u>	9, 10, 11, 12, 13, 14, 15, 16, 17, 18, 19, 20, 21, 22, 24 mm





Chrome adjustable wrenches

Chrome vanadium steel
Standards: ISO 6787

Large ridged knurl for easier adjustment
Measurement scale on wrench



Part Number	Size
CR3023	6" - 150 mm
CR3024	8" - 200 mm
CR3025	10" - 250 mm
CR3026	12" - 300 mm
CR3027	15" - 375 mm
CR3028	18" - 450 mm

Set of 9 ball end hex keys

Chrome vanadium steel
Standards : ISO 2936

Ball end hex to access fasteners up to an angle of 30°



Part Number	metric SAE
CR4000 mm	1.5, 2, 2.5, 3, 4, 5, 6, 8, 10 mm
CR4500 in	1/16, 5/64, 3/32, 1/8, 5/32, 5/16, 1/4, 5/64, 3/8"

CLAMPING TOOLS





Forged steel vise with swivel-base

High tensile forged steel body with a machined anvil

Precision glide for effortless operation

Replaceable inserted jaws made of case-hardened chromium molybdenum steel

Professional quality for perfect stability

Supplied with 360° swivel base (removable for rigid base mounting)

Pipe holder

Part Number	Jaw size	Opening (in)
EA5125	125 mm - 5"	6-5/16"
EA6150	150 mm - 6"	7-15/32"

- High quality
- Long-lasting
- Resistant
- Rugged



Removable magnetic jaw sets with prismatic surface

Aluminum

4 V-grooves for vertical (3) and horizontal (1) clamping of round parts

Upper rests to hold thin pieces

Magnetic mounting

Universal, fits on all 5" and 6" vises



Part Number	Jaw size
EA8125	125 mm - 5"
EA8150	150 mm - 6"

Woodworkers Vise

Large clamping area

Clamping screws and chrome guides

Pre-drilled holes for mounting protective wooden jaws

The retractable stop with use of a bench hold-down increases clamping capacity

Trigger action releases the screw permitting quick opening or closing of the vise

Part Number	Length	Opening (in)
EA7225	225 mm - 8-7/8"	13-3/8"



Woodworkers Vise

Large clamping area (150 x 40 mm)

Ideal for woodworking

Built-in plastic jaws incorporated to avoid marking parts

Part Number	Length	Opening (in)
EA7155	155 mm - 6-3/32"	5-15/16"



Multi-use folding table

Portable

Rugged

High stability

Wooden table top

Lateral steel corner protectors

45 mm diameter tube feet

Quick and easy assembly and disassembly

Part Number *CR7230*

Length	Width	Height	Weight (lb)
1100 mm	600 mm	820 mm	55
43-5/16"	23-5/8"	32-9/32"	55



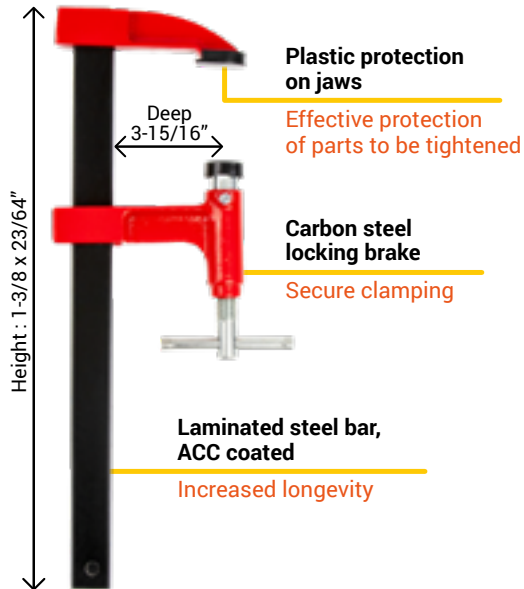

One-handed clamps



Clamping power up to 10 000 N



Epoxy coated high-resistant spheroidal graphite cast iron jaws

One-handed system to leverage force for maximum effortless clamping

Part Number	Opening (in)	Weight (lb)
CR4650	19-11/16"	5
CR4651	23-5/8"	6
CR4652	31-1/2"	7
CR4653	39-3/8"	8
CR4654	47-1/4"	9

Quick support rods

Keeps various items in place such as ventilation ducts, ceiling moldings, bath contours, etc.

Sliding expandable sleeve

Final adjustment by screws

Secure locking

Non-slip rubber glide pads

■ **Maintain**
■ **Strength**
■ **Lock**



Part number	Opening min. cm	in	Weight Capacity Kg	Opening max . cm	in	Weight Capacity Kg
CR4600	65	2'1"	200	115	3'9"	130
CR4601	101	3'3"	200	177	5'9"	120
CR4602	160	5'3"	200	290	9'6"	50
CR4603	210	6'10"	200	390	12'19"	40



Ball pein hammer with hickory handle

Standards: ISO 15601

Rugged and resistant hickory handle

Hardened steel carbon XC head

Metal wedges to maintain head on handle



Part Number	Length	Top Weight
CR4005	12-5/8"	12 oz

Ball pein hammers with fiberglass handle

Intensive use

High-strength and durable fiberglass handle

Fully tempered forged steel head ideal for professional use

Elongated collar provides protection against mishits

New and improved rubber grip prevents slippage and increases shock absorption

Weight distribution of the hammer for more efficiency: maximizing the force of the blow and reducing fatigue

- Less effort required
- Rugged
- High performance

Part Number	Length	Top Weight
CR4024	13-1/2"	24 oz
CR4032	13-25/32"	32 oz



- Shock absorption
- Reduced fatigue



CHOOSE YOUR PLIERS ...

ANTI-FATIGUE PLIERS

Return springs reduce the risk of muscle problems and fatigue



Spring loaded diagonal cutting pliers with composite handle PRECI-R

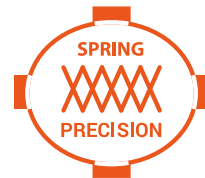

Lineman's pliers with composite handle UNIV-R

- Less effort
- Lightweight
- Precision

Return spring



A high percentage of workers are affected by a work-related disorder (WMSDs). Represents **7.3% of all causes of absenteeism** in the workplace.

Solution

The pliers' integrated return spring is designed to reduce the risk of the user developing WMSDs. The spring in the composite shafts add more comfort. The ergonomics of the composite handle is designed with an anti-slippage safety spud grip for better comfort during use

Cuts all materials

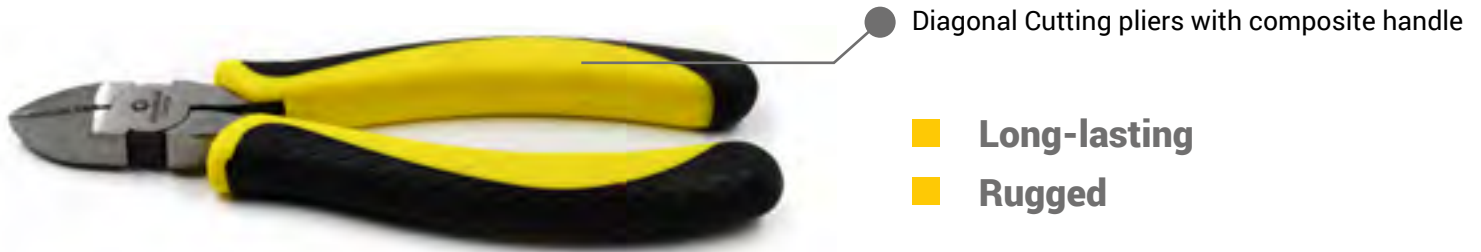

Tighten and cut



Access confined spaces and handle small pieces



Tighten small and large pieces

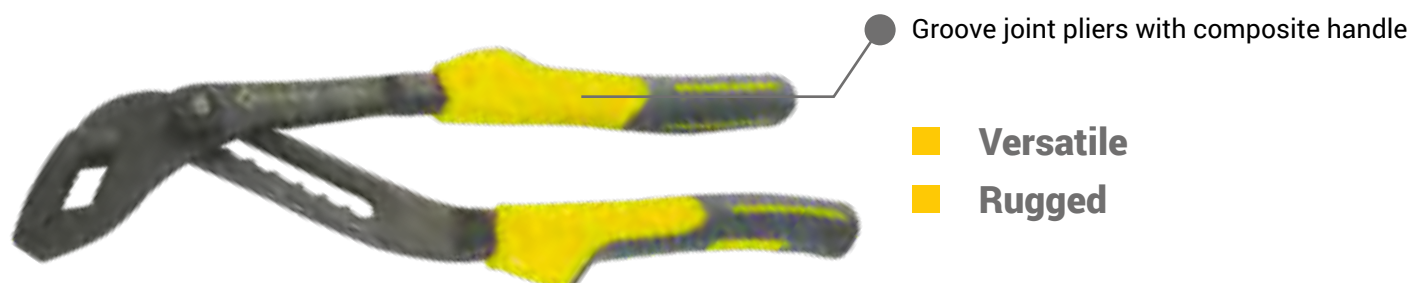

ANTI-FATIGUE PLIERS



Spring loaded diagonal cutting pliers with composite handle PRECI-R

Chrome vanadium steel
Standards: ISO 5749

High frequency surface treatment for improved performance

The return spring hidden in the clamp head limits repetitive movements

Part Number	Length
CR4003	6-1/2"

- **Less effort**
- **Lightweight**
- **Precision**



Our pliers with return spring reduce risk of injury and provide more comfort with the composite handle.



Lineman's pliers with composite handle UNIV-R

Chrome vanadium steel
Standards: ISO 5749

Built-in spring for better flexibility

Increased clamping force with serrated jaws and wire cutting function

Part Number	Length
CR4006	6-1/2"

Groove joint pliers with composite handle

Chrome vanadium steel
Standards: ISO 8976

Easier reach in limited spaces

Convenient/handy ergonomic composite handle

Large opening capacity: 2-5/16" - 8 positions

Part Number	Length
CR4004	9-7/8"

- **Strength**
- **Precision**
- **Rugged**



All our pliers are equipped with a composite handle for unmatched grip and comfort

Diagonal Cutting pliers with composite handle

Hardened carbon steel
Polished finish

Cuts all materials

Part Number	Length
CR4100	7-1/2"

- Long-lasting
- Rugged



Lineman's pliers with composite handle

Hardened carbon steel
Polished finish

Tightening and cutting

Part Number	Length
CR4101	8"

- Heavy duty
- Serrated nose



Additional tightening space

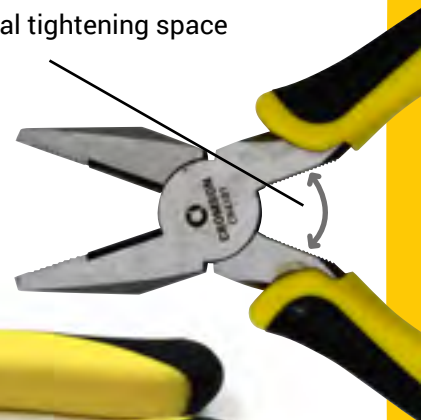

Composite Long Nose pliers

Hardened carbon steel
Polished finish

Tightening for small pieces and confined spaces

Part Number	Length
CR4102	7-1/2"

- Durable
- Precise



LOCKING PLIERS

PERFORMANCE in 4 FEATURES



PERFORM R

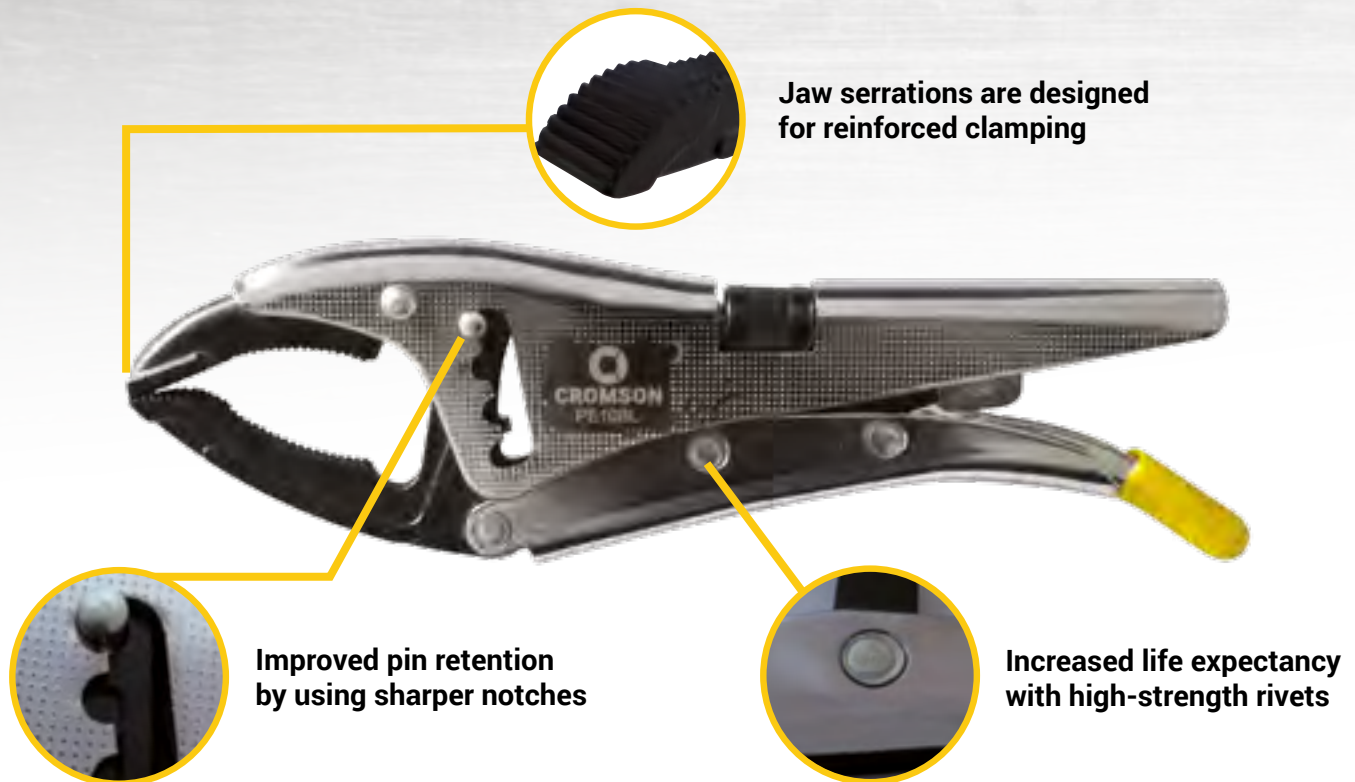

Protection of the jaws by cataphoresis, resistance to saline mist

Jaws of forged steel, grooved and hardened with serrations at 58/60 HRC; 16 mm wide



Protection of the body by chromium plating, thicker casing and handle



Only one hand needed for clamping and unlocking ergonomic grip

Precise and powerful tightening (300 to 600 daN) with consistently parallel jaws



Large opening with knurled wheel for clamping force adjustment



Application: Metal / Sheet Metal / Locksmith

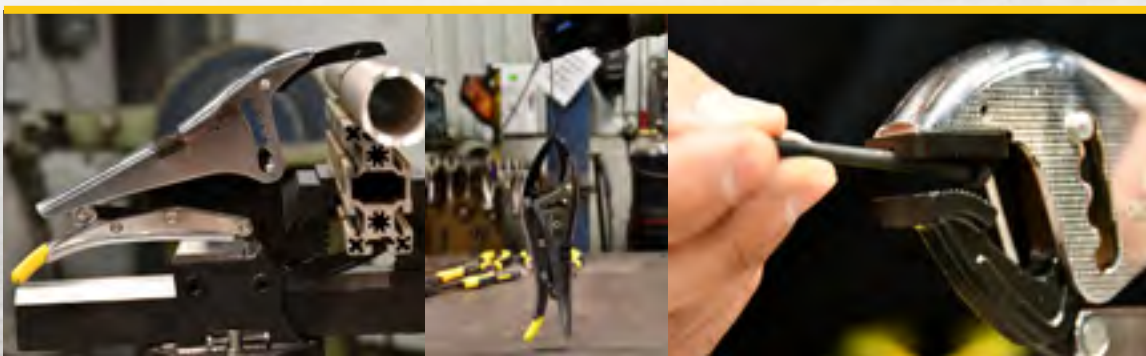

Large capacity locking pliers, long jaws 4 setting positions - PERFORM-R1

Part Number PE10BL

Length	Opening	Jaws depth
250 mm	80 mm	73 mm
10 in	3-1/8 in	2-7/8 in

The shape of the jaws allows many tightening possibilities



Large capacity locking pliers, short jaws 4 setting positions - PERFORM-R2

Part Number PE9BC

Length	Opening	Jaws depth
220 mm	55 mm	44 mm
9 in	2-1/8 in	1-3/4 in

Flat upper jaws allow a larger tightening surface as well as increasing torque

V-shaped upper jaw for tightening of round objects



Large capacity locking pliers, deep jaws 6 setting positions - PERFORM-R3

Part Number PE11BXL

Length	Opening	Jaws depth
270 mm	130 mm	90 mm
11 in	5-1/8 in	3-1/2 in

Large tightening capacity with greater opening and clearance

6 setting positions for easy adjustment and tightening precision



Locking C-Clamp pliers

Chrome vanadium jaws

Large opening ideal for bodywork, assembly, welding and sheet metal work

Part Number *PE12GC*



Length	Jaw depth	Opening	Max. tightening
280 mm	62 mm	90 mm	250 daN
11-1/32"	2-7/16"	3-9/16"	

Curved Jaw Locking Pliers

Chrome vanadium jaws

Multi-purpose locking pliers ideal for holding round workpieces.

Part Number *PE13MC*



Length	Jaw depth	Opening	Max. tightening
250 mm	32 mm	55 mm	530 daN
9-27/32"	1-17/64"	2-11/64"	

Locking Clamp pliers with single adjusting screw

RUGGED CONSTRUCTION

The auto-tightening system with the integrated screw brake offers longer service life and saves time, while providing anti-spatter protection

Copper trapezoidal screw reduces adjustment time and provides anti-spatter protection

Large opening with one-hand clamping adjustment

SECURITY

Pressed rivets, reduces the risk of snagging gloves or clothing

ERGONOMICS

15° self-levelling copper support pad provides superior clamping surface adherence

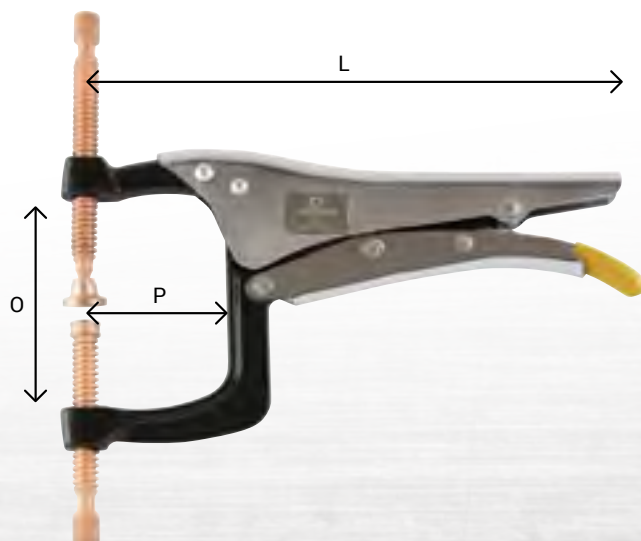

Protection of forged steel jaws against corrosion by cataphoresis



Chrome-plated body for added protection and durability

Part Number	Number of screws	Length (L)	Jaw depth (P)	Opening (O)	Weight (lb)
PSJ100	1	233 mm - 9"	43 mm - 1-11/16"	51 mm - 2-1/64"	1.7
PSJ101	1	252 mm - 10"	63 mm - 2-31/64"	81 mm - 3-3/16"	1.9
PSJ102	1	332 mm - 13"	143 mm - 5-5/8"	108 mm - 4-1/4"	2.7
PSJ200	2	252 mm - 10"	63 mm - 2-31/64"	75 mm - 2-61/64"	2.1

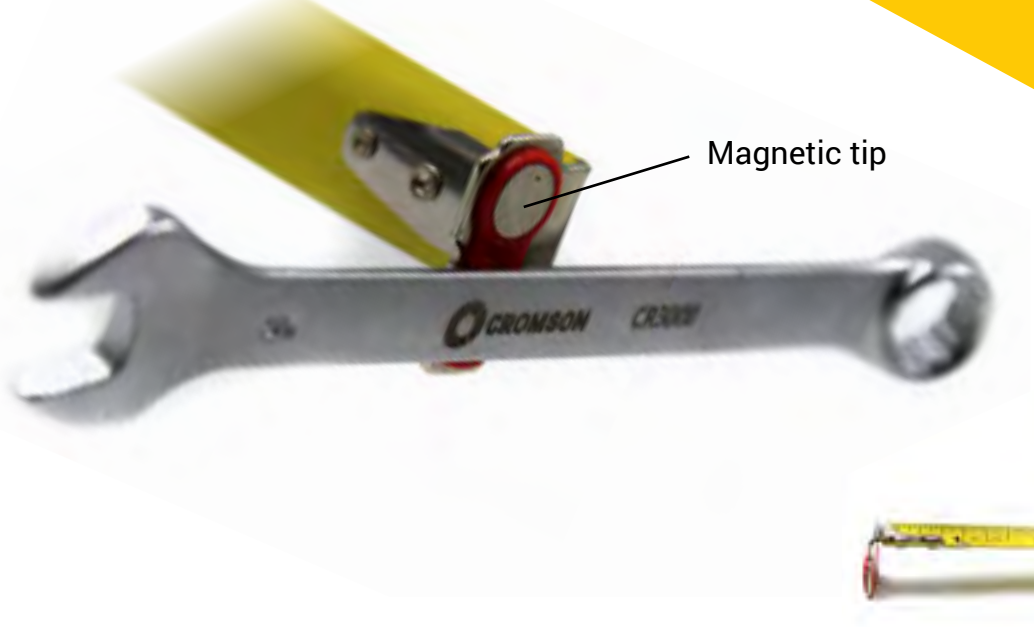

Magnetic tip



Belt clip

Magnetic tip measuring tapes

Ergonomic non-slip molded grip

Fully shock and abrasion resistant with nylon coated jaws

Metric and SAE readings

Belt clip

2 magnetic tips for one-handed operation

Blade brake allows better control when retracting



Part Number	Size
RM534	5 m - 16'
RM81	8 m - 26'

19 mm
3/4"

25 mm
1"



SAE — metric

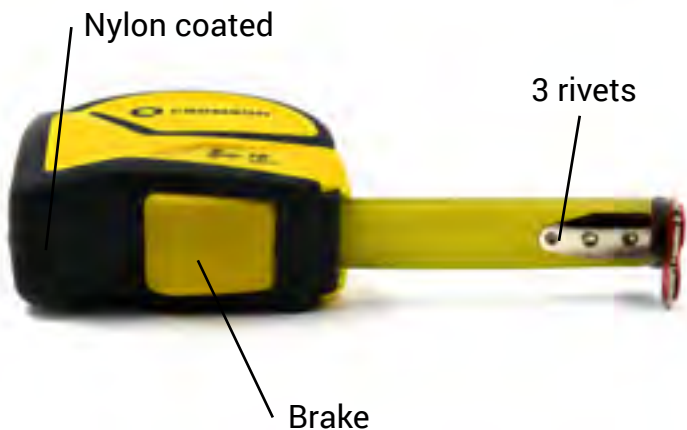

Nylon coated

3 rivets

Brake



OUR STORAGE SOLUTIONS

ONE MOTTO AND A SINGLE GOAL :
CREATE CUSTOM STORAGE SOLUTIONS FOR YOUR NEEDS



EXPERTISE

Trade specialists to help you with your projects.



QUALITY

A service dedicated to custom manufacturing
using only the best available materials



INNOVATION

Rethink your storage, custom solutions tailored
to your needs



BEFORE

AFTER

CUSTOM-CUT FOAM STORAGE



*** FREE WITH THE PURCHASE OF CROMSON TOOLS**

+ SPACE
CHOOSE A SET WITH ITS PREDEFINED STORAGE OR THE OPTION OF TAILOR-MADE!
WALL DISPLAY AVAILABLE.

+ TIME
FIND YOUR TOOLS QUICKLY.

+ MONEY
ORGANIZED - YOU WON'T FORGET A SINGLE TOOL ON THE JOB.

+ DURABILITY
EACH TOOL IS SURROUNDED BY FOAM FOR SECURE PROTECTION.

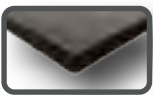

"SELECT" FOAM
SELECT, EASY TO PERSONALIZE,
THE PRECUT FOAM OFFERS A FULLY CUSTOMIZABLE SOLUTION FOR ALL YOUR
TOOL STORAGE.



AXIOM AR8-PRO+
USED TO CUT FOAM

COMPATIBLE WITH THE PACKOUT

Milwaukee



CROM-BOX SOLUTIONS

Contact your distributor to create your custom storage solution
with your existing tools or accessories

ABS storage box - CR5000



- Ergonomic
- Stackable
- Solid
- Waterproof
- Portable

ALU storage box - CR5001



- Compact
- Light
- Convenient
- Portable

See our tool sets designed with your needs in mind, on page 44 to 47



Create your set with our flexible foam

Foam "SELECT"

Part Number	Thickness
CR96837	1-1/8"
CR96838	2-1/4"

Two available mounting positions:

Vertical : wall display

Horizontal : drawers, CROM-BOX, tray



Stepped foam with multiple 1/8" thick layers
for precise cutting to fit individual tools

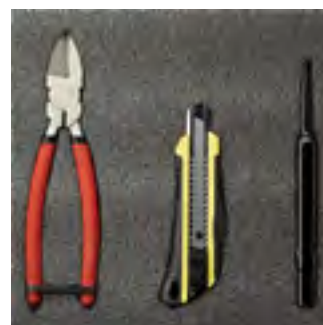



44 piece metric tool set - CROM-BOX 44M

- 11 6-point sockets, 1/4" drive: 4, 5, 5.5, 6, 7, 8, 9, 10, 11, 12, 13 mm
- 12 6-point sockets, 1/2" drive: 10, 11, 12, 13, 15, 17, 18, 20, 21, 22, 24, 25 mm
- 2 ratchets: 1/4" and 1/2" drive
- 2 extensions, 1/4" drive: 50 and 100 mm
- 2 extensions, 1/2" drive: 125 and 250 mm
- 2 universal joints: 1/4" and 1/2" drive
- 11 12-point combination wrenches: 9, 10, 11, 12, 13, 15, 17, 18, 21, 22, 24 mm
- 1 set of 9 ball end hex keys (metric)
- 1 ABS storage box - 18 litres and PREMIUM high density foam included

Part Number CR6000



42 piece SAE tool set - CROM-BOX 42I

- 10 6-point sockets, 1/4" drive: 3/16, 7/32, 1/4, 9/32, 5/16, 11/32, 3/8, 13/32, 7/16, 1/2"
- 12 6-point sockets, 1/2" drive: 3/8, 7/16, 1/2, 9/16, 5/8, 11/16, 3/4, 13/16, 7/8, 15/16, 1, 1-1/16"
- 2 ratchets: 1/4" and 1/2" drive
- 2 extensions, 1/4" drive: 2" and 4"
- 2 extensions, 1/2" drive: 5" and 10"
- 2 universal joints: 1/4" and 1/2" drive
- 10 12-point combination wrenches: 3/8, 7/16, 1/2, 9/16, 5/8, 11/16, 3/4, 7/8, 15/16, 1"
- 1 set of 9 ball end hex keys (SAE)
- 1 ABS storage box - 18 litres and PREMIUM high density foam included

Part Number CR6500



Discover our hand trucks page 87
to effortlessly transport your tool sets



10 piece tool set - CROM-BOX 100

- 1 bit holder socket, 1/4" drive
- 1 adjustable wrench 8"
- 1 set of 30 bits and bit holder
- 1 bit holder screwdriver, 1/4" drive
- 1 composite spring loaded cutting pliers PRECI-R
- 1 composite lineman's pliers UNIV-R
- 1 composite groove joint pliers
- 1 ball pein hammer - 12 oz
- 1 magnetic tip measuring tape 5 m - 16'
- 1 ABS storage box - 18 litres and PREMIUM high density foam included

Part Number CR6600



ABS storage box - without tools

ABS (Acrylonitrile butadiene styrene)
Standards: ISO 5749

Top and side handles

Stackable and waterproof case

Box will support a 220 lb load
and has a capacity up to 55 lbs

Part Number CR5000

Capacity	Length	Width	Height	Weight (lb)
18 litres	17.6"	14.1"	4.6"	4.4



Stackable cases



48 piece metric tool set - ALU-M

- 11 6-point sockets, 1/4" drive: 4, 5, 5.5, 6, 7, 8, 9, 10, 11, 12, 13 mm
- 15 6-point sockets, 1/2" drive: 10, 11, 12, 13, 14, 15, 16, 17, 18, 19, 20, 21, 22, 24, 25 mm
- 2 ratchets: 1/4" and 1/2" drive
- 2 extensions, 1/4" drive: 50 and 100 mm
- 2 extensions, 1/2" drive: 125 and 250 mm
- 2 universal joints: 1/4" and 1/2" drive
- 1 bit holder socket, 1/4" drive
- 9 12-point combination wrenches: 9, 10, 12, 13, 14, 15, 17, 18, 19 mm
- 1 set of 30 bits and bit holder
- 1 bit holder screwdriver, 1/4" drive
- 1 groove joint pliers with composite handle
- 1 ALU storage box - 7.4 litres and PREMIUM high density foam included

Part Number CR6001

44 piece SAE tool set - ALU-I

- 10 6-point sockets, 1/4" drive: 3/16, 7/32, 1/4, 9/32, 5/16, 11/32, 3/8, 13/32, 7/16, 1/2"
- 12 6-point sockets, 1/2" drive: 3/8, 7/16, 1/2, 9/16, 5/8, 11/16, 3/4, 13/16, 7/8, 15/16, 1, 1-1/16"
- 2 ratchets: 1/4" and 1/2" drive
- 2 extensions, 1/4" drive: 2" and 4"
- 2 extensions, 1/2" drive: 5" and 10"
- 2 universal joints: 1/4" and 1/2" drive
- 1 bit holder socket, 1/4" drive
- 9 12-point combination wrenches: 3/8, 7/16, 1/2, 9/16, 5/8, 11/16, 3/4, 15/16, 1"
- 1 set of 30 bits and bit holder
- 1 bit holder screwdriver, 1/4" drive
- 1 groove joint plier with composite handle
- 1 ALU storage box - 7.4 litres and PREMIUM high density foam included included

Part Number CR6501

27 piece metric/SAE tool set, 1/2" drive - ALU SELECT

- 12 6-point sockets, 1/2" drive: 10, 11, 12, 13, 14, 15, 16, 17, 18, 19, 20, 21 mm
- 11 6-point sockets, 1/2" drive: 3/8, 7/16, 1/2, 9/16, 5/8, 11/16, 3/4, 13/16, 7/8, 15/16, 1"
- 1 ratchet: 1/2" drive
- 2 extensions, 1/2" drive: 125 and 250 mm / 5" and 10"
- 1 universal joint: 1/2" drive
- 1 ALU storage box - 7.4 litres and SELECT foam included

Part Number CR6201



ALU storage box - without tools

Aluminum

Compact and lightweight for easy transport

Convenient for storing tools of all sizes

Built-in elastic straps for optimized storage

Metal clasps

Reinforced corners

Part Number CR5001

Capacity	Length	Width	Height	Weight (lb)
7.4 litres	18.8"	8.5"	3"	2.8



PROFITABILITY WARRANTY

CROMSON's profitability warranty certifies that our products are designed, to save you time, to be more durable and to perform as specified.

CROMSON designs, selects and markets quality products for professional use. Products in this category deteriorate or become damaged due to normal wear and tear, so they are not exchangeable. This includes tools for cutting or removing material (resharpenable tools, drill bits, saw blades or knife blades), abrasive tools (grinding wheels, sanding discs, deburring discs or cutting discs).



SAFETY GUIDE

This information is provided for the convenience of abrasive disc users. Read the instructions provided with the tools carefully before using them.

Risks related to the use of abrasive discs:

- Poor selection of type of grinding wheel
- Incorrect mounting
- Excessive speed
- Inappropriate safety shield
- Dust

Prevent serious accidents by taking simple precautions:

DO'S	DON'TS
<ul style="list-style-type: none"> • Handle and store abrasive discs with care • Inspect discs before mounting to ensure they are not damaged • Check that the grinding wheel arbour hole fits the machine shaft correctly • Use the mounting blotters that come with the grinding wheels • Ensure the correct setting of the workpiece • Use the grinding wheel guard provided on the machine • Let the new discs spin for a minute before starting • Wear eye safety goggles and extra face and hand protection if required • Turn off the power before removing the disc 	<ul style="list-style-type: none"> • Use wheels that have fallen or been damaged • Use excessive pressure when mounting the wheel between the flanges • Exceed the established rotation speed • Use dirty, flat and smooth mounting flanges • Gently tighten the mounting nut • Use a disc for a different application than intended • Start the machine before attaching the guard • Stand in front of a disc while the machine is running

LEGEND AND SECURITY ICONS

These warning icons appear on our products and packaging. They are intended to draw your attention to the safety measures to be put in place when using the products.



Wear safety gloves



Wear a respiratory mask



Refer to the operator's manual and safety guide



Do not use on angle



ALUMINUM



STEEL



STAINLESS STEEL



CONCRETE



WOOD



ABRASIVES

ONE MOTTO AND A SINGLE GOAL:
TO PROMOTE AND ENSURE THE CONTINUITY OF A JOB WELL DONE



EXPERTISE

Products researched and designed for professional use that meet or exceed industry standards



QUALITY

An expert choice of the best materials for maximum performance



INNOVATION

Smart pictograms assure simplified identification of products. Ease of handling because of innovative packaging

CROMSON IDENTIFICATION



Type 1 Cutting Wheels ALPHA CUT 01



Aluminum oxide
Standards: ANSI B7.1
Cuts steel, stainless steel, sheet metal, pipe or structural steel
Reinforced with fiberglass



Quick, straight and precise cutting at a competitive price

Part Number	Size	Max rpm	Packaging
MT145045	4-1/2 x .045 x 7/8"	13580	x 25
MT150045	5 x .045 x 7/8"	12225	x 25



Special packaging for better handling and increased visibility

Type 27 Cutting Wheels ALPHA CUT 27



Aluminum oxide
Standards: ANSI B7.1
Cuts steel, stainless steel, sheet metal, pipe or structural steel
Reinforced with fiberglass



Quick, straight and precise cutting at a competitive price

Flush cutting capability

Part Number	Size	Max rpm	Packaging
MT274545	4-1/2 x .045 x 7/8"	13580	x 25
MT275045	5 x .045 x 7/8"	12225	x 25





Type 27 Grinding Wheels ALPHA TRIM

S SS

Aluminum oxide
Standards: ANSI B7.1



Grinding applications on carbon steel and/or stainless steel

Coarse stock removal, smoothing welds and beveling

Not recommended for soft materials

High stock removal rate, long lasting with superior performance

Part Number	Size	Max rpm	Packaging
MR274514	4-1/2 x 1/4 x 7/8"	13580	x 25
MR275014	5 x 1/4 x 7/8"	12225	x 25



Type 27 Flap Discs DELTA FLEX

S SS AL

Aluminum oxide and zirconium
Standards: ANSI B7.1



Superior performance and durability
Quiet, less dust and lower vibration levels
Trimable backing

i **2 steps in one :**
Grinding and polishing with an excellent quality finish

Different grits available

Part Number	Size	Max rpm	Grit	Packaging
DL451040	4-1/2 x 5/8-11"	13300	40	x 10
DL451060	4-1/2 x 5/8-11"	13300	60	x 10
DL451080	4-1/2 x 5/8-11"	13300	80	x 10
DL452040	4-1/2 x 7/8"	13300	40	x 10
DL452060	4-1/2 x 7/8"	13300	60	x 10
DL452080	4-1/2 x 7/8"	13300	80	x 10
DL501040	5 x 5/8-11"	12000	40	x 10
DL501060	5 x 5/8-11"	12000	60	x 10
DL501080	5 x 5/8-11"	12000	80	x 10
DL502040	5 x 7/8"	12000	40	x 10
DL502060	5 x 7/8"	12000	60	x 10
DL502080	5 x 7/8"	12000	80	x 10

Type 27 Coating removal Discs DELTA CARB

S S SS AL

Silicon carbide
Standards: ANSI B7.1



Superior performance and durability

Clean and polish corrosion, rust, paint, glue, varnish and calcium and lime deposits on all surfaces

Open structure prevents buildup

For all materials

Part Number	Size	Max rpm	Packaging
MD455811	4-1/2 x 5/8-11"	12000	x 10
MD505811	5 x 5/8-11"	11000	x 10



Type 1 Bench Grinding Wheels 6x1x1

Brown aluminum oxide: ferrous metals
Green silicon carbide: non-ferrous metals
Standards: ANSI B7.1



General use for different applications

Does not overheat the workpiece, increasing productivity

Comes with different arbor bushings (from 1/2" to 7/8")

Part Number	Materials	Max rpm	Grit
MAO6011G	Brown aluminum oxide	4140	Coarse 36/46
MAO6011M	Brown aluminum oxide	4140	Medium 60/80
MAO6011F	Brown aluminum oxide	4140	Fine 100/120
MAC6011M	Green silicon carbide	4140	Medium 60
MAC6011F	Green silicon carbide	4140	Fine 80
MAC6011E	Green silicon carbide	4140	Extra-fine 120



CROMSON

DELTA FLEX

Type TR Surface conditioning discs SURFX

S

SS

AL



Aluminum oxide
Standards: ANSI B7.1

Combination of quality abrasives and solid synthetic mesh at a competitive price

Thick grain layer for extended life

Open construction of non-woven material provides aggressive cutting action while cleaning and eliminating imperfections on metal surfaces

Features a resin designed to resist fraying when used on sharp edges

Use on portable tools, quick change



Grit : Coarse



Grit : Medium

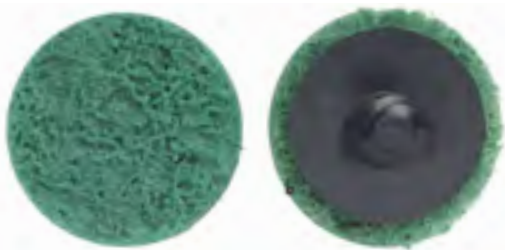

Grit : Fine

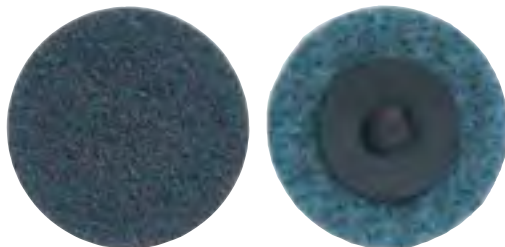

Grit : Very fine

Part Number	Size	Grit
TR020010	2"	Fine
TR020020	2"	Medium
TR020030	2"	Coarse
TR030000	3"	Very Fine
TR030010	3"	Fine
TR030020	3"	Medium
TR030030	3"	Coarse

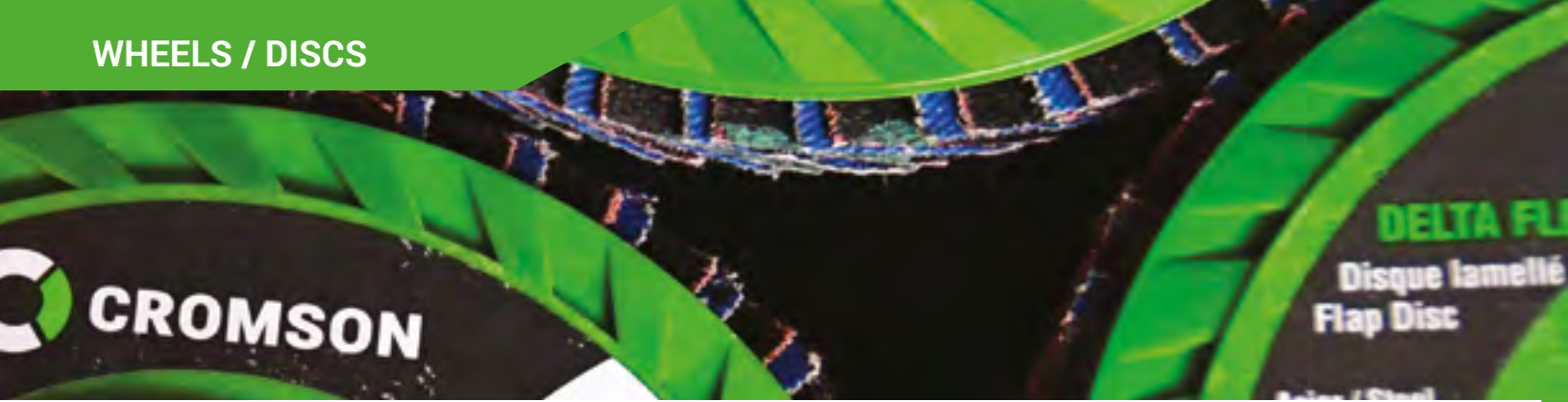

Type TR Coating removal Discs DELTA CARB S AL W

Silicon carbide
Standards: ANSI B7.1



Quick change method offers faster and more aggressive cutting with improved finish

Ideal for stripping coatings on a variety of materials, such as wood, steel, aluminum, asphalt, concrete, stainless steel, plastic, stone, nickel, tile and drywall

Open structure minimizes clogging

Good alternative to wire and steel brushes

Does not rust



Part Number	Size	Grit
MD0200TR	2"	Very coarse
MD0300TF	3"	Very coarse

Type TR Disc Holder

Standards: ANSI B7.1

Quick clamping / loosening (TR) system allows tool changes that improve productivity while reducing downtime



Part Number	Size	Density
DS0200TR	2"	Medium
DS0300TR	3"	Medium



DS0300TR



DS0200TR

Type 41 Cut-off Wheel ALPHA CUT T41 - STEEL

Aluminum oxide grinding wheel for gas saw



Fast and efficient cuts without burrs in steel



Two reinforced layers for increased safety

Designed for general cutting of all steel and stainless steel parts, including steel structure for tarred steel pipes, sheet metal, cables and solid parts of medium to small diameters

Part Number	Size	Packaging
MT411418A	14 x 1/8 x 20 mm	x 10

Type 41 Cut-off Wheel ALPHA CUT T41 - Concrete

Silicon carbide grinding wheel for gas saws



Fast and efficient concrete cutting



Two reinforced layers for more safety

Designed for cutting bricks, blocks, concrete or other masonry materials

Part Number	Size	Packaging
MT411418B	14 x 1/8 x 20 mm	x 10

Abrasive Cloth Rolls

Aluminum oxide
Standards: ANSI B7.1

Durability and uniform sanding

Cotton cloth backing offers high resistance and flexibility for various uses

Different grits available

Part Number	Size	Grit
RA112080	1-1/2" x 50 yd.	80
RA112100	1-1/2" x 50 yd.	100
RA112120	1-1/2" x 50 yd.	120
RA112150	1-1/2" x 50 yd.	150
RA112180	1-1/2" x 50 yd.	180
RA112280	1-1/2" x 50 yd.	280
RA112320	1-1/2" x 50 yd.	320



Abrasive Roll Dispenser

Perforated bracket for wall hanging

Easily allows cutting strips to a desired length

Choose an assortment of five shop rolls from our wide range of grits 80 to 320

Dispenser sold without rolls

Part Number PRA5

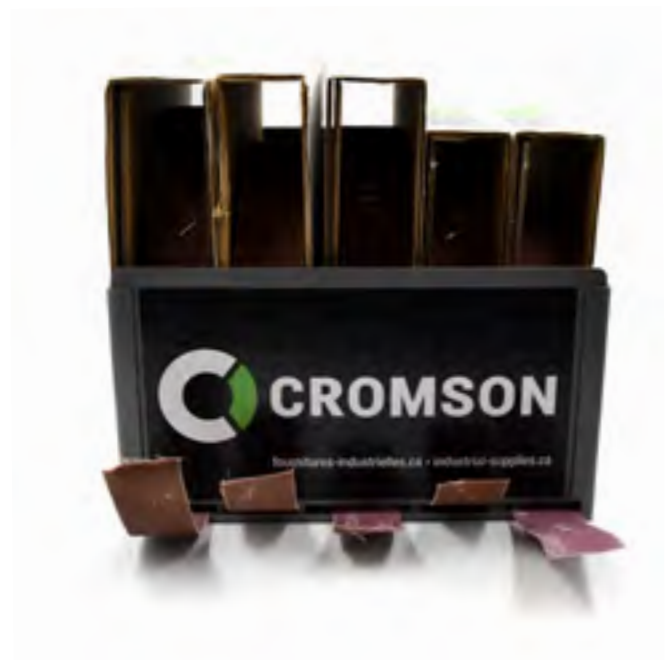



A SELECTION OF OUR BEST PRODUCTS
FOR GENERAL USE



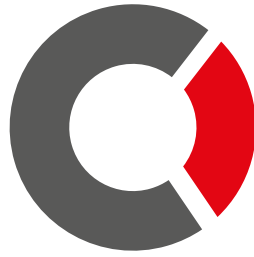

CUTTING TOOLS

ONE MOTTO AND A SINGLE GOAL:
TO PROVIDE A HIGH-QUALITY RESULT WITH POWERFUL TOOLS



EXPERTISE

Products researched and designed for professional use that meet or exceed industry standards



QUALITY

High-quality materials meeting the specifications and criteria of our experts



INNOVATION

Ease of use and adequate tools for all types of applications

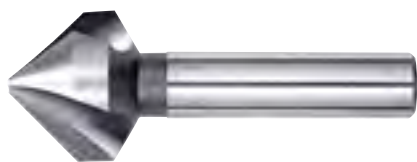

90° / 82° Countersinks - 3 Flutes



Material : HSS-E Cobalt / carbide

Series : M08 - Metric / SAE

Use : Machine

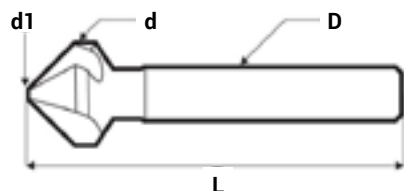

High performance countersink is a highly improved version of the traditional multiflute milling cutter :

- grooves opened wide to allow chip evacuation
- high positive cut
- constant profile relief for easier regrind
- dimensions are in accordance with 90° and 82° screw caps
- we recommend the usage of coolant

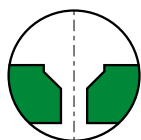

90°C COUNTERSINK

Part Number M0805 HSS Co	Part Number M0805-C HSS Co TiN	Part Number M8090 Carbide	Diameter d Metric	Diameter d SAE	d1 max	D h9	L +/-1
77200300	77200305	77200500	6.30		1.50	5.00	45
77200400	77200405		6.35	1/4	1.50	6.35	45
77200410	77200415		7.93	5/16	2.00	6.35	45
	77200365	77200510	8.30		2.50	6.00	50
77200420	77200425		9.52	3/8	2.50	6.35	50
77200310	77200315	77200520	10.40			6.00	50
77200320	77200325	77200530	12.40		2.80	8.00	56
77200430	77200435		12.70	1/2	2.90	6.35	50
77200440	77200445		15.87	5/8	3.20	9.52	60
77200330	77200335	77200540	16.50		3.20	8.00	56
77200450	77200455		19.05	3/4	3.50	9.52	60
77200340	77200345	77200550	20.50		3.50	10.00	63
77200350	77200355		25.00		3.80	10.00	67
77200460	77200465		25.40	1	3.80	9.52	70

82°C COUNTERSINK

Part Number M0882 HSS Co	Diameter d Metric	Diameter d SAE	d1 max	D h9	L +/-1
77200600	6.35	1/4	1.50	6.35	45
77200610	7.93	5/16	2.00	6.35	45
77200620	9.52	3/8	2.50	6.35	50
77200630	12.70	1/2	2.90	6.35	50
77200640	15.87	5/8	3.20	9.52	60
77200650	19.05	3/4	3.50	9.52	60
77200660	25.40	1	3.80	9.52	70



HSS Hand taps sets - Metric or SAE

Material: HSS - High speed steel
 General application : Ferrous and non-ferrous
 Use : Manual
 Hole type : Through bore or blind hole
 Surface treatment : Bright
 Tap length : Standard



Part Number	Description	Diameter Thread	Number Thread	Number flutes	Thread limit	OAL	Tap length
76004401	HSS - 6-32-NC	6	32	3	H3	2	11/16
76004411	HSS - 8-32-NC	8	32	4	H3	2-1/8	3/4
76004431	HSS - 10-24-NC	10	24	4	H3	2-3/8	7/8
76004441	HSS - 12-24-NC	12	24	4	H3	2-3/8	15/16
76004461	HSS - 10-32-NF	10	32	4	H3	2-3/8	7/8
76004471	HSS - 1/4-20-NC	1/4	20	4	H3	2-1/2	1
76004491	HSS - 1/4-28-NF	1/4	28	4	H3	2-1/2	1
76004511	HSS - 5/16-18-NC	5/16	18	4	H3	2-23/32	1-1/8
76004521	HSS - 5/16-24-NF	5/16	24	4	H3	2-23/32	1-1/8
76004531	HSS - 3/8-16-NC	3/8	16	4	H3	2-15/16	1-1/4
76004551	HSS - 3/8-24-NF	3/8	24	4	H3	2-15/16	1-1/4
76004561	HSS - 7/16-14-NC	7/16	14	4	H3	3-5/32	1-7/16
76004581	HSS - 7/16-20-NF	7/16	20	4	H3	3-5/32	1-7/16
76004591	HSS - 1/2-13-NC	1/2	13	4	H3	3-3/8	1-11/16
76004611	HSS - 1/2-20-NF	1/2	20	4	H3	3-3/8	1-11/16
76004621	HSS - 9/16-12-NC	9/16	12	4	H3	3-19/32	1-11/16
76004641	HSS - 9/16-18-NF	9/16	18	4	H3	3-19/32	1-11/16
76004651	HSS - 5/8-11-NC	5/8	11	4	H3	3-13/16	1-13/16
76004671	HSS - 5/8-18-NF	5/8	18	4	H3	3-13/16	1-13/16
76004681	HSS - 3/4-10-NC	3/4	10	4	H3	4-1/4	2
76004701	HSS - 3/4-16-NF	3/4	16	4	H3	4-1/4	2



Part Number	Description	Diameter Thread	Number Thread	Number flutes	Thread limit	OAL	Tap length
76004801	HSS - M3-0.5	M3	0.5	3	D3	1-15/16	5/8
76004811	HSS - M4-0.7	M4	0.7	3	D4	2-1/8	3/4
76004831	HSS - M5-0.8	M5	0.8	3	D4	2- 3/8	7/8
76004841	HSS - M6-1	M6	1	4	D5	2-1/2	1
76004861	HSS - M8-1.25	M8	1.25	4	D5	2-23/32	1-1/8
76004871	HSS - M10-1.25	M10	1.25	4	D5	2-15/16	1-1/4
76004891	HSS - M10-1.5	M10	1.5	4	D6	2-15/16	1-1/4
76004901	HSS - M12-1.75	M12	1.75	4	D6	3-3/8	1-21/32



HSS SAE Hand taps



Material: HSS - High speed steel

General application : Ferrous and non-ferrous

Use : Manual

Hole type : Through bore or blind hole

Surface treatment : Bright

Tap length : Standard

Part Number	Description	Type of finish	Diameter Thread	Number Thread	Number flutes	Thread limit	OAL	Tap length
76004400	HSS - 6-32 -NC1	TAPER	6	32	3	H3	2	11/16
76004405	HSS - 6-32 -NC2	PLUG	6	32	3	H3	2	11/16
76004410	HSS - 6-32 -NC3	BOTTOMING	6	32	3	H3	2	11/16
76004415	HSS - 8-32 -NC1	TAPER	8	32	4	H3	2-1/8	3/4
76004420	HSS - 8-32 -NC2	PLUG	8	32	4	H3	2-1/8	3/4
76004425	HSS - 8-32 -NC3	BOTTOMING	8	32	4	H3	2-1/8	3/4
76004430	HSS - 10-24 -NC1	TAPER	10	24	4	H3	2-3/8	7/8
76004435	HSS - 10-24 -NC2	PLUG	10	24	4	H3	2-3/8	7/8
76004440	HSS - 10-24 -NC3	BOTTOMING	10	24	4	H3	2-3/8	7/8
76004445	HSS - 12-24 -NC1	TAPER	12	24	4	H3	2-3/8	15/16
76004450	HSS - 12-24 -NC2	PLUG	12	24	4	H3	2-3/8	15/16
76004455	HSS - 12-24 -NC3	BOTTOMING	12	24	4	H3	2-3/8	15/16
76004460	HSS - 10-32 -NF1	TAPER	10	32	4	H3	2-3/8	7/8
76004465	HSS - 10-32 -NF2	PLUG	10	32	4	H3	2-3/8	7/8
76004470	HSS - 10-32 -NF3	BOTTOMING	10	32	4	H3	2-3/8	7/8
76004475	HSS - 1/4-20 -NC1	TAPER	1/4	20	4	H3	2-1/2	1
76004480	HSS - 1/4-20 -NC2	PLUG	1/4	20	4	H3	2-1/2	1
76004485	HSS - 1/4-20 -NC3	BOTTOMING	1/4	20	4	H3	2-1/2	1
76004490	HSS - 1/4-28 -NF1	TAPER	1/4	28	4	H3	2-1/2	1
76004495	HSS - 1/4-28 -NF2	PLUG	1/4	28	4	H3	2-1/2	1.
76004500	HSS - 1/4-28 -NF3	BOTTOMING	1/4	28	4	H3	2-1/2	1
76004505	HSS - 5/16-18 -NC1	TAPER	5/16	18	4	H3	2-23/32	1-1/8
76004510	HSS - 5/16-18 -NC2	PLUG	5/16	18	4	H3	2-23/32	1-1/8
76004515	HSS - 5/16-18 -NC3	BOTTOMING	5/16	18	4	H3	2-23/32	1-1/8
76004520	HSS - 5/16-24 -NF1	TAPER	5/16	24	4	H3	2-23/32	1-1/8
76004525	HSS - 5/16-24 -NF2	PLUG	5/16	24	4	H3	2-23/32	1-1/8
76004530	HSS - 5/16-24 -NF3	BOTTOMING	5/16	24	4	H3	2-23/32	1-1/8
76004535	HSS - 3/8-16 -NC1	TAPER	3/8	16	4	H3	2-15/16	1-1/4
76004540	HSS - 3/8-16 -NC2	PLUG	3/8	16	4	H3	2-15/16	1-1/4
76004545	HSS - 3/8-16 -NC3	BOTTOMING	3/8	16	4	H3	2-15/16	1-1/4
76004550	HSS - 3/8-24 -NF1	TAPER	3/8	24	4	H3	2-15/16	1-1/4
76004555	HSS - 3/8-24 -NF2	PLUG	3/8	24	4	H3	2-15/16	1-1/4



**CUTTING
TOOLS**

Expertise • Quality • Innovation

cromson.com

HSS SAE Hand taps

Material: HSS - High speed steel
 General application : Ferrous and non-ferrous
 Use : Manual
 Hole type : Through bore or blind hole
 Surface treatment : Bright
 Tap length : Standard



Part Number	Description	Type of finish	Diameter Thread	Number Thread	Number flutes	Thread limit	OAL	Tap length
76004560	HSS - 3/8-24 -NF3	BOTTOMING	3/8	24	4	H3	2-15/16	1-1/4
76004565	HSS - 7/16-14 -NC1	TAPER	7/16	14	4	H3	3-5/32	1-7/16
76004570	HSS - 7/16-14 -NC2	PLUG	7/16	14	4	H3	3-5/32	1-7/16
76004575	HSS - 7/16-14 -NC3	BOTTOMING	7/16	14	4	H3	3-5/32	1-7/16
76004580	HSS - 7/16-20 -NF1	TAPER	7/16	20	4	H3	3-5/32	1-7/16
76004585	HSS - 7/16-20 -NF2	PLUG	7/16	20	4	H3	3-5/32	1-7/16
76004590	HSS - 7/16-20 -NF3	BOTTOMING	7/16	20	4	H3	3-5/32	1-7/16
76004595	HSS - 1/2-13 -NC1	TAPER	1/2	13	4	H3	3-3/8	1-11/16
76004600	HSS - 1/2-13 -NC2	PLUG	1/2	13	4	H3	3-3/8	1-11/16
76004605	HSS - 1/2-13 -NC3	BOTTOMING	1/2	13	4	H3	3-3/8	1-11/16
76004610	HSS - 1/2-20 -NF1	TAPER	1/2	20	4	H3	3-3/8	1-11/16
76004615	HSS - 1/2-20 -NF2	PLUG	1/2	20	4	H3	3-3/8	1-11/16
76004620	HSS - 1/2-20 -NF3	BOTTOMING	1/2	20	4	H3	3-3/8	1-11/16
76004625	HSS - 9/16-12 -NC1	TAPER	9/16	12	4	H3	3-19/32	1-11/16
76004630	HSS - 9/16-12 -NC2	PLUG	9/16	12	4	H3	3-19/32	1-11/16
76004635	HSS - 9/16-12 -NC3	BOTTOMING	9/16	12	4	H3	3-19/32	1-11/16
76004640	HSS - 9/16-18 -NF1	TAPER	9/16	18	4	H3	3-19/32	1-11/16
76004645	HSS - 9/16-18 -NF2	PLUG	9/16	18	4	H3	3-19/32	1-11/16
76004650	HSS - 9/16-18 -NF3	BOTTOMING	9/16	18	4	H3	3-19/32	1-11/16
76004655	HSS - 5/8-11 -NC1	TAPER	5/8	11	4	H3	3-13/16	1-13/16
76004660	HSS - 5/8-11 -NC2	PLUG	5/8	11	4	H3	3-13/16	1-13/16
76004665	HSS - 5/8-11 -NC3	BOTTOMING	5/8	11	4	H3	3-13/16	1-13/16
76004670	HSS - 5/8-18 -NF1	TAPER	5/8	18	4	H3	3-13/16	1-13/16
76004675	HSS - 5/8-18 -NF2	PLUG	5/8	18	4	H3	3-13/16	1-13/16
76004680	HSS - 5/8-18 -NF3	BOTTOMING	5/8	18	4	H3	3-13/16	1-13/16
76004685	HSS - 3/4-10 -NC1	TAPER	3/4	10	4	H3	4-1/4	2
76004690	HSS - 3/4-10 -NC2	PLUG	3/4	10	4	H3	4-1/4	2
76004695	HSS - 3/4-10 -NC3	BOTTOMING	3/4	10	4	H3	4-1/4	2
76004700	HSS - 3/4-16 -NF1	TAPER	3/4	16	4	H3	4-1/4	2
76004705	HSS - 3/4-16 -NF2	PLUG	3/4	16	4	H3	4-1/4	2
76004710	HSS - 3/4-16 -NF3	BOTTOMING	3/4	16	4	H3	4-1/4	2



HSS metric Hand taps



Material: HSS - High speed steel

General application : Ferrous and non-ferrous

Use : Manual

Hole type : Through bore or blind hole

Surface treatment : Bright

Tap length : Standard

Part Number	Description	Type of finish	Diameter Thread	Number Thread	Number flutes	Thread limit	OAL	Tap length
76004800	HSS - M3-0.5 -1	TAPER	M3	0.5	3	D3	1-15/16	5/8
76004805	HSS - M3-0.5 -2	PLUG	M3	0.5	3	D3	1-15/16	5/8
76004810	HSS - M3-0.5 -3	BOTTOMING	M3	0.5	3	D3	1-15/16	5/8
76004815	HSS - M4-0.7 -1	TAPER	M4	0.7	3	D4	2-1/8	3/4
76004820	HSS - M4-0.7 -2	PLUG	M4	0.7	3	D4	2-1/8	3/4
76004825	HSS - M4-0.7 -3	BOTTOMING	M4	0.7	3	D4	2-1/8	3/4
76004830	HSS - M5-0.8 -1	TAPER	M5	0.8	3	D4	2-3/8	7/8
76004835	HSS - M5-0.8 -2	PLUG	M5	0.8	3	D4	2-3/8	7/8
76004840	HSS - M5-0.8 -3	BOTTOMING	M5	0.8	3	D4	2-3/8	7/8
76004845	HSS - M6-1 -1	TAPER	M6	1	4	D5	2-1/2	1
76004850	HSS - M6-1 -2	PLUG	M6	1	4	D5	2-1/2	1
76004855	HSS - M6-1 -3	BOTTOMING	M6	1	4	D5	2-1/2	1
76004860	HSS - M8-1.25 -1	TAPER	M8	1.25	4	D5	2-23/32	1-1/8
76004865	HSS - M8-1.25 -2	PLUG	M8	1.25	4	D5	2-23/32	1-1/8
76004870	HSS - M8-1.25 -3	BOTTOMING	M8	1.25	4	D5	2-23/32	1-1/8
76004875	HSS - M10-1.25 -1	TAPER	M10	1.25	4	D5	2-15/16	1-1/4
76004880	HSS - M10-1.25 -2	PLUG	M10	1.25	4	D5	2-15/16	1-1/4
76004885	HSS - M10-1.25 -3	BOTTOMING	M10	1.25	4	D5	2-15/16	1-1/4
76004890	HSS - M10-1.5 -1	TAPER	M10	1.5	4	D6	2-15/16	1-1/4
76004895	HSS - M10-1.5 -2	PLUG	M10	1.5	4	D6	2-15/16	1-1/4
76004900	HSS - M10-1.5 -3	BOTTOMING	M10	1.5	4	D6	2-15/16	1-1/4
76004905	HSS - M12-1.75 -1	TAPER	M12	1.75	4	D6	3-3/8	1-21/32
76004910	HSS - M12-1.75 -2	PLUG	M12	1.75	4	D6	3-3/8	1-21/32
76004915	HSS - M12-1.75 -3	BOTTOMING	M12	1.75	4	D6	3-3/8	1-21/32

Drill Press Vise



Fixed hardened steel jaws with horizontal (1) and vertical (3)
Ideal for clamping thin parts, metals, plastics, wood, etc.

Securely hold workpieces for reliable and accurate drilling
Small footprint thanks to the clamping screw that fits into the operating handle

3 machined faces

3 positions: on base, on edge and on front face

Stability assured thanks to lateral mounting notches

Part Number	Length	Opening (in)
EA7344	344 mm - 13-9/16"	4-5/16"

Carbide Burrs SIGMA + double cut

The quality of the tungsten carbide substrate increases durability, performance, tooth hardness and cutting edges



Increased material removal and reduced chip breakage

Universal cut provides versatility and adaptability to grinding machines and automatic numerical control machines

Part Number	D1	L1	D2	L2
BC000SA3	3/8"	3/4"	1/4"	2-1/2"
BC000SA5	1/2"	1"	1/4"	2-3/4"
BC000SC3	3/8"	3/4"	1/4"	2-1/2"
BC000SC5	1/2"	1"	1/4"	2-3/4"
BC000SF3	3/8"	3/4"	1/4"	2-1/2"
BC000SF5	1/2"	1"	1/4"	2-3/4"

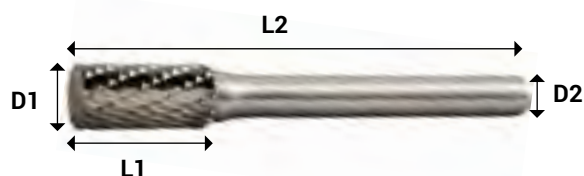

Type SA - Cylindrical without End Cut



Finishing contours and right angle corners

Type SC - Cylindrical without Radius



Better tool control provides smoother operation

Type SF - Tree with Radius



Round edges and concave cuts

Multi-step drills



Material :

Hardness 63 HRc for the machining of steels up to 800 N/mm²

Copper, brass, bronze, aluminum up to 6% Si

Straight flute

Series : M02 - Metric

Use : Machine

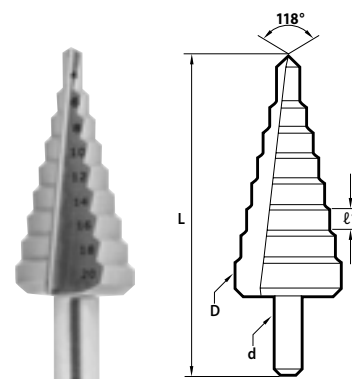

Part Number	Diameter	Capacity Opening	L	l1	d
77100400	12	4, 5, 6, 7, 8, 9, 10, 11, 12	79	5	6
77100410	20	4, 6, 8, 10, 12, 14, 16, 18, 20	67	3	8
77100420	30	4, 6, 8, 10, 12, 14, 16, 18, 20, 22, 24, 26, 28, 30	100	4	10
77100430	38	6, 9, 13, 16, 19, 21, 23, 26, 29, 32, 35, 38	100	4	10
77100440	12, 20 and 30	Set includes 77100400 - 77100410 et 77100420			



HSS BORADO mechanic's length drills - Intensive use

Material: HSS - High speed steel

Use: Manual and machine

Finish: Black & Gold

Split Point: 135 °



Nitride treated, heavy-duty construction increases tool life and performance

Black & Gold surface treatment for maximum lubricity

Usable in a wide range of materials including stainless steel

3-flat shank helps to reduce slippage



Part Number	Diameter	Type Thread	Length Total	Length Flute
CD0116	1/16	Round	1-7/8	7/8
CD0564	5/64	Round	2	1
CD0332	3/32	Round	2-1/4	1-1/4
CD0764	7/64	Round	2-3/8	1-5/16
CD0108	1/8	Round	2-1/2	1-7/16
CD0964	9/64	Round	2-5/8	1-9/16
CD0532	5/32	Round	2-3/4	1-11/16
CD1164	11/64	Round	2-7/8	1-13/16
CD0316	3/16	3-Flat	3	1-7/8
CD1364	13/64	3-Flat	3-1/8	1-15/16
CD0732	7/32	3-Flat	3-1/4	2
CD1564	15/64	3-Flat	3-3/8	2-1/16
CD0104	1/4	3-Flat	3-1/2	2-3/32
CD1764	17/64	3-Flat	3-5/8	2-1/8
CD0932	9/32	3-Flat	3-3/4	2-1/4
CD1964	19/64	3-Flat	3-7/8	2-3/8
CD0516	5/16	3-Flat	4	2-1/2
CD2164	21/64	3-Flat	4-1/16	2-9/16
CD1132	11/32	3-Flat	4-1/8	2-5/8
CD2364	23/64	3-Flat	4-3/16	2-11/16
CD0308	3/8	3-Flat	4-1/4	2-11/16
CD2564	25/64	3-Flat	4-5/16	2-3/4
CD1332	13/32	3-Flat	4-3/8	2-13/16
CD2764	27/64	3-Flat	4-7/16	2-7/8
CD0716	7/16	3-Flat	4-1/2	2-15/16
CD2964	29/64	3-Flat	4-5/8	3
CD1532	15/32	3-Flat	4-3/4	3-1/8
CD3164	31/64	3-Flat	4-7/8	3-1/4
CD0102	1/2	3-Flat	5	3-3/8

Set of 8 HSS BORADO S&D drills – 1/2" shank

Material: HSS - High speed steel

Use: Manual and machine

Finish: Black & Gold

Split Point: 118 °



Nitride treated, heavy-duty construction increases tool life and performance

Black & Gold surface treatment for maximum lubricity

Usable in a wide range of materials including difficult to machine materials such as stainless steel

Part Number	Diameter	Stem type	Length Total	Length of flute
CD3364	33/64	1/2 - 3-Flat	6	3
CD1732	17/32	1/2 - 3-Flat	6	3
CD3564	35/64	1/2 - 3-Flat	6	3
CD0916	9/16	1/2 - 3-Flat	6	3
CD3764	37/64	1/2 - 3-Flat	6	3
CD1932	19/32	1/2 - 3-Flat	6	3
CD3964	39/64	1/2 - 3-Flat	6	3
CD0508	5/8	1/2 - 3-Flat	6	3
CD4164	41/64	1/2 - 3-Flat	6	3
CD2132	21/32	1/2 - 3-Flat	6	3
CD4364	43/64	1/2 - 3-Flat	6	3
CD1116	11/16	1/2 - 3-Flat	6	3
CD4564	45/64	1/2 - 3-Flat	6	3
CD2332	23/32	1/2 - 3-Flat	6	3
CD4764	47/64	1/2 - 3-Flat	6	3
CD0304	3/4	1/2 - 3-Flat	6	3
CD4964	49/64	1/2 - 3-Flat	6	3
CD2532	25/32	1/2 - 3-Flat	6	3
CD5164	51/64	1/2 - 3-Flat	6	3
CD1316	13/16	1/2 - 3-Flat	6	3
CD5364	53/64	1/2 - 3-Flat	6	3
CD2732	27/32	1/2 - 3-Flat	6	3
CD5564	55/64	1/2 - 3-Flat	6	3
CD0708	7/8	1/2 - 3-Flat	6	3
CD5764	57/64	1/2 - 3-Flat	6	3
CD2932	29/32	1/2 - 3-Flat	6	3
CD5964	59/64	1/2 - 3-Flat	6	3
CD1516	15/16	1/2 - 3-Flat	6	3
CD6164	61/64	1/2 - 3-Flat	6	3
CD3132	31/32	1/2 - 3-Flat	6	3
CD6364	63/64	1/2 - 3-Flat	6	3
CD0001	1	1/2 - 3-Flat	6	3



Set of 8 HSS BORADO drills - 1/2" shank



Metal box
Material: HSS - High speed steel
Finish: Black & Gold
Split Point: 118 °
Shank type : 1/2 3-Flats

Part Number	Size
CD08M	9/16" to 1" by 16ths



Set of 29 HSS BORADO drills - Mechanic's length



Metal box
Material: HSS - High speed steel
Finish: Black & Gold
Split Point: 135 °
Shank type : 3-Flats

Part Number	Size
CD29M	1/16" to 1/2" by 64ths



Set of 29 HSS BORADO drills - Mechanic's length



Plastic box
Material: HSS - High speed steel
Finish: Black & Gold
Split Point: 135 °
Shank type : 3-Flats

Part Number	Size
CD29P	1/16" to 1/2" by 64ths

ASK FOR OUR CUTTING TOOL CATALOGUE

with its 4 complete product ranges and 4,500 items



RECORD

Steels - stainless steel
2 - 4 fl. (square, radius
and ball nose)

STAR

Stainless steel - cast iron
- alloyed steel
4 - 5 - 7 fl. (square, radius)

ALLIANCE

Titanium
4 - 5 fl. (square, radius)

PISTON

Hardened steel up to 60 HRC
6 fl. (square, radius)

TURBINE

Roughing, steels
- stainless steel
- exotic 4 fl. (chamfer)

OXYGEN

High Speed Machining (HSM)
<60 HRC. 4-5 fl. (wide radius
for high feed)

TAPERMILL

Pre-machining NPT Thread
4 fl. (conical)

DRIVER

Finishing mold (up to 60 HRC)
2 fl. (ball nose)

MOTION

Aluminum
2-3 fl. (square, radius
and ball nose)

BOSS

Roughing - aluminum
3 fl. (chamfer)

MAGNAT

Steels - stainless steel - exotic
5 fl. (square, radius)

PERFORMANCE

Titanium - super Alloys
- stainless steel - 4 fl. (square,
radius and ball nose)

BOOSTER

Super Alloys - titanium
- stainless steel
5-7-9 fl. (square, radius)



EFFICIENCY - C1000

Materials < 48 HRc
External fluid (3xD)

EFFICIENCY - C1100

Materials < 48HRc
Internal coolant supply (3xD)

CROMINOX - C2100

Stainless steel - titanium - inconel
Internal coolant supply (3-5xD)

MINIATURE - C3100

Steels - stainless steel - PH
Internal coolant supply (5-8-12xD)

CROMSTEEL - C4100

Steels - cast iron - hardened steel
Internal coolant supply (3-5-8xD)

CONCENTRICITY - C5100

Concentricity - coaxiality
Internal coolant supply (5-8-12xD)
Double margin

HIGH PRECISION - C6100

Surface finish, tolerance
Internal coolant supply (5xD) 4 fl.

DRILLREAM - C7100

Simultaneous drilling / boring
Internal coolant supply (3-5xD)
Triple margin

CROMALU - C8100

Aluminum - Brass - Copper
Internal coolant supply (3-5-12xD)

HIGH PERFORMANCE C9100

Steels -
stainless steel - cast iron (high feed)
Internal coolant supply (3-5-8xD)

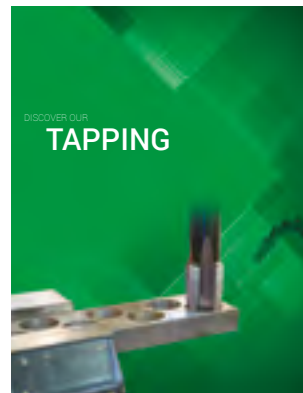

CRP3

Materials < 25 HRc
Spiral Point and Spiral Flute

CRPS Din / ANSI / NPT

Materials < 35 HRc
Spiral Point and Spiral Flute

CRM

Stainless steel - alloyed steel
Spiral Point and Spiral Flute

CRS

Tool steel - titanium - nickel
Spiral Point and Spiral Flute

CRN

Aluminum - Steel <25 HRc
Spiral Point and Spiral Flute
Rolled thread

HAND TAP

Ferrous and non-ferrous
Taper, plug and bottoming

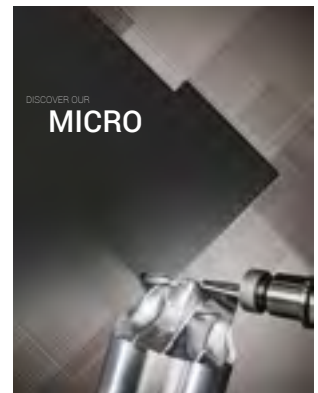

CENTER DRILL

60° (double) HSS / carbide
Short and long

MULTI-STEP DRILL

HSS-E
Thin sheet material

MINIATURE DRILL

Carbide
0.10 to 1.00mm
External fluid

PROFILING END DRILL

Carbide
Micro ball nose 220°

BALL NOSE END MILL

Carbide
Micro hemispherical

CHAMFERING END MILL

Carbide - 90° and 60°
Profiling

THREADING END MILL

Carbide (thread M0.8 to M10)
CNC interpolation

ENGRAVING TOOL

Carbide
Tip : .05 to .20mm

COUNTERSINK

HSS-E and carbide
90° and 82°

CORNER ROUNDING END MILL

Carbide
Radius : 0.5 to 3.0mm

MICRO END MILL

Carbide (1.5-5-8xD)
Steel - hardened steel <67 HRc.
titanium, aluminum

O-RING AND CIRCLIP END MILL

Carbide 1.4 to 3.8mm



**CUTTING
TOOLS**

Expertise • Quality • Innovation





MAINTENANCE

ONE MOTTO AND A SINGLE GOAL:
ENSURE THE SUCCESS OF YOUR PROJECTS
IN AN ENVIRONMENT OF CONTINUED PERFORMANCE



EXPERTISE

Products researched and designed for professional use that meet or exceed industry standards



QUALITY

Tools that meet your expectations and ensure a job well done



INNOVATION

A wide range that adapts to all your professional and personal projects



Suitable for all types of paints, dyes and varnishes
Natural wood handle
Poly/nylon bristles

Paint brush flat sash nylon

Part Number	Width	Thickness	Length
CR7200	1" - 25 mm	7/16" - 11 mm	2-1/4" - 57 mm
CR7201	2" - 50 mm	1/2" - 13 mm	2-1/2" - 64 mm
CR7202	3" - 75 mm	3/4" - 19 mm	2-3/4" - 70 mm



Paint brush angular sash nylon

Part Number	Width	Thickness	Length
CR7250	2" - 50 mm	1/2" - 13 mm	2-1/2" - 64 mm
CR7251	2-1/2" - 64 mm	5/8" - 16 mm	2-3/4" - 70 mm
CR7252	3" - 75 mm	5/8" - 16 mm	2-3/4" - 70 mm

Blue H.D.P.E tarp - Heavy duty

H.D.P.E. (High Density Polyethylene)
Weave construction : 10 x 10
GSM (Gram per square meter) : 110

Waterproof and resistant to chemicals, tears and mildew

Aluminum rust resistant grommets every 3'

Polyethylene Rope Reinforced edges



Part Number	Size
CR9000	6' x 8'
CR9001	8' x 10'
CR9002	10' x 12'
CR9003	10' x 15'
CR9004	15' x 20'
CR9005	18' x 24'
CR9006	20' x 30'
CR9007	30' x 40'
CR9008	30' x 50'
CR9009	40' x 50'
CR9010	40' x 60'





2 colors :

Natural White made of natural nylon for indoor use only

UV Black made of weather-resistant nylon good for indoor or outdoor use

Natural nylon cable ties

CSA approved

Easy to insert and pull through

Higher tensile strength achieved from one piece design

Part Number (x100)	Part Number (x1000)	Color	Tensile strength	Length	Width	Thickness
CR9100	CR9101	Natural white	18 lb	4.10	.095	.042
CR9102	CR9103	Black UV	18 lb	4.10	.095	.042
CR9104	CR9105	Natural white	18 lb	6.18	.095	.042
CR9106	CR9107	Black UV	18 lb	6.18	.095	.042
CR9108	CR9109	Natural white	18 lb	8.10	.095	.042
CR9110	CR9111	Black UV	18 lb	8.10	.095	.042
CR9112	CR9113	Natural white	40 lb	5.80	.140	.049
CR9114	CR9115	Black UV	40 lb	5.80	.140	.049
CR9116	CR9117	Natural white	40 lb	8.80	.140	.049
CR9118	CR9119	Black UV	40 lb	8.80	.140	.049
CR9120		Natural white	40 lb	10.96	.140	.049
CR9121		Black UV	40 lb	10.96	.140	.049
CR9122		Natural white	40 lb	14.25	.140	.049
CR9123		Black UV	40 lb	14.25	.140	.049
CR9124	CR9125	Natural white	50 lb	7.50	.180	.052
CR9126	CR9127	Black UV	50 lb	7.50	.180	.052
CR9128		Natural white	50 lb	11.20	.180	.052
CR9129		Black UV	50 lb	11.20	.180	.052
CR9130		Natural white	50 lb	14.25	.180	.052
CR9131		Black UV	50 lb	14.25	.180	.052
CR9132		Natural white	50 lb	17.00	.180	.052
CR9133		Black UV	50 lb	17.00	.180	.052



Extendable LED flashlight with magnet

Aluminum construction with stainless steel clip

Instant maximum LED lighting

Flexible and directional rotation of the handle 360° for optimal visibility

4 LR44 batteries included

Part Number	Color
CR7001	Blue
CR7002	Black
CR7003	Red



Magnet lifts up to 5 lbs

Extendable telescopic arm up to 22 inches





One-piece construction for increased strength and durability

Combines roll head and angle pry bar ends for better access in tight work areas

Round tapered handle and pinch point end to pry and lift heavy objects



Utility bar



Tempered Alloy steel
Electrostatic powder coating resistant to corrosion

Ideal for general use

Part Number	Length	Weight (lb)
CR7352	15"	1,5



Wrecking Bars



Tempered Alloy steel
Electrostatic powder coating resistant to corrosion

Ideal for demolition and prying

Part Number	Length	Weight (lb)
CR7350	24"	4,25
CR7351	36"	6,25



Pry Bar

Tempered Alloy steel
Electrostatic powder coating resistant to corrosion

Hexagonal shank for maximum comfort

Chisel and crow end are precision ground

Part Number	Length	Weight (lb)
CR7353	60"	18

Winter shovels

- Thermoformed molding
- Poly blade offers flexibility in cold temperatures
- Solid ash handle is stained to help prevent chipping, and water damage
- D-style grip makes using this shovel comfortable and easy



Part Number	Type	Handle length	Blade width	Handle type
CR7404	Snow shovel	53.5"	14.5" x 7.5"	D
CR7405	Snow pusher	56"	20.5" x 6"	D
CR7406	Snow pusher	56.5"	25.5" x 5"	D



CR7406



CR7405



CR7404



Durable black tempered steel blade engineered to withstand heavy use
Solid ash handle is stained to help prevent chipping, and water damage



All purpose shovel



Ideal for most applications

D-style grip makes using this shovel comfortable and easy

Part Number	Blade width	Handle length	Handle type	Weight (lb)
CR7400	11,25"	46.5"	D	5,2



Square point shovel



Ideal for scooping and moving dirt, gravel and other landscaping materials

Forward turned footsteps on the blade for additional leverage

Part Number	Blade width	Handle length	Handle type	Weight (lb)
CR7401	10.50"	61.5"	Long	3.8



Round point shovel



Ideal for digging, planting and moving earth
Forward turned footsteps on the blade for additional leverage

Part Number	Blade width	Handle length	Handle type	Weight (lb)
CR7402	8.50"	63.5"	Long	4.2



Aluminum Grain scoop N°8

Ideal for moving grain, seed, feed, fertilizers
and other granulated materials

Aluminum blade is lightweight and durable

Handle: hardwood, natural finish

Part Number	Blade width	Handle length	Handle type	Weight (lb)
CR7403	13"	65"	Long	3.8





Utility Knife Ratchet Lock Blade

Stainless steel blade channel

Ergonomic non-slip grip

Ratchet locking mechanism

Ideal for cutting sturdy building materials such as drywall, linoleum, carpet and many others

Replacement steel blade: *CR7363*

Part Number	Blade width
<i>CR7360</i>	18 mm - 23/32"



Utility Knife Slide Lock Blade

Stainless steel blade channel

Plastic Handle

Slide locking mechanism

Replacement steel blade: *CR7364*

Part Number	Blade width
<i>CR7361</i>	9 mm - 11/32"

Self-loading knife for intensive use

- Stainless steel blade channel
- Ergonomic non-slip rubber grip
- Slide lock mechanism automatically locks the blade to the desired size
- Handle composed of five blades SK5 for ejection and fast loading
- Ideal for cutting sturdy building materials such as drywall, linoleum, carpet and many others

Replacement steel blade: CR7365

Part Number	Blade width
CR7362	18 mm - 23/32"



Replacement steel blades

Steel

Package: x10

Part Number	Segments per blade	Blade width	Use with the model
CR7363	x 8	18 mm - 23/32"	CR7360
CR7364	x 12	9 mm - 11/32"	CR7361
CR7365	x 8	18 mm - 23/32"	CR7362





Forged steel vise with swivel-base

High tensile casting body with a machined anvil

Precision glide for effortless operation

Replaceable inserted jaws made of case-hardened chromium molybdenum steel

Professional quality for excellent stability

Supplied with 360° swivel base (removable for rigid base mounting)

Pipe holder

Part Number	Jaw size	Opening (po)
EA5125	125 mm - 5"	6-5/16"
EA6150	150 mm - 6"	7-15/32"

- High quality
- Long-lasting
- Resistant
- Rugged



Removable magnetic jaw sets with prismatic surface

Aluminum

4 V-grooves for vertical (3) and horizontal (1) clamping of round parts

Upper rests to hold thin pieces

Magnetic mounting

Universal, fits on all 5" and 6" vises

Part Number	Jaw size
EA8125	125 mm - 5"
EA8150	150 mm - 6"



Woodworkers Vise

Large clamping area

Clamping screws and chrome guides

Pre-drilled holes for mounting protective wooden jaws

The retractable stop with use of a bench hold-down increases clamping capacity

Trigger action releases the screw permitting quick opening or closing of the vise

Part Number	Length	Opening (in)
EA7225	225 mm - 8-7/8"	13-3/8"



Woodworkers Vise

Large clamping area (150 x 40 mm)

Ideal for woodworking

Built-in plastic jaws incorporated to avoid marking parts

Part Number	Length	Opening (in)
EA7155	155 mm - 6-3/32"	5-15/16"



Multi-use folding table

■ Portable

■ Rugged

■ High stability

Wooden table top

Lateral steel corner protectors

45 mm diameter tube feet

Quick and easy assembly and disassembly

Part Number *CR7230*

Length	Width	Height	Weight (lb)
1100 mm	600 mm	820 mm	55
43-5/16"	23-5/8"	32-9/32"	55



WARRANTY POLICY

CROMSON ensures that its products are manufactured according to industry standards and that each of them is guaranteed against manufacturing defects during its lifetime *

One-year limited warranty on material handling products used under normal conditions. Applies to defective parts (deformation, breakage, etc.) or premature wear (confirmed by the expertise of CROMSON technical services).



Any products in the CROMSON material handling range** that become defective under normal conditions of use during the warranty period will be exchanged free of charge by CROMSON.

For more details on application conditions and warranty terms of use, refer to page 6.

SAFETY GUIDE

This information is provided as an indication to the users of material handling products. Read the instructions provided with the tools carefully before using them.

Prevent serious accidents by taking simple precautions:

DO'S	DON'TS
<ul style="list-style-type: none"> • Ensure the safety of workers • Ensure that the free height of the load is enough to avoid a collision • Ensure that the chain is properly lodged in the pulleys and is not twisted, deformed or damaged. • Check the brake operation • Check the operation of the latch • Check the lubricant • Inspect the hooks for any nicks, gouges, cracks, and separation marks, or twists 	<ul style="list-style-type: none"> • Lift above the load conditions • Lift people or lift loads over people's heads • Use with defective parts • Use if the load is applied at the end of the hook • Hammering the lever • Use extension cords • Remove warning labels

*Product used for the intended application

** Included in this warranty: chain hoists, lever hoists, manual trolleys

COMMITMENT

Our material handling products are certified to:: AMSE B30.11 and AMSE B30.16.
Included:

- Nameplate
- Serial number
- Capacity
- Certificate of inspection and tested with declaration of conformity
- User Guide



MATERIAL HANDLING

ONE MOTTO AND A SINGLE GOAL:
EFFECTIVE SOLUTIONS ADAPTED TO YOUR NEEDS
IN COMPLIANCE WITH SAFETY STANDARDS

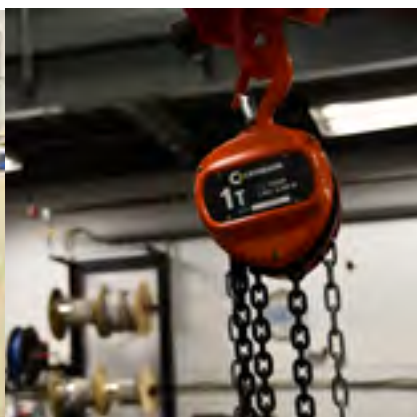

EXPERTISE

Products researched and designed for professional use that meet or exceed industry standards



QUALITY

Reliable and resistant materials to ensure safe working conditions



INNOVATION

A wide range combining durability, toughness and visibility

Trolleys CCM Series

*Tested at 125% of rated capacity (certificate included)

Capacity of 1T and 2T

One-year warranty

ASME B30.11 Certified

Nameplate including serial number and capacity



SECURITY

Built-in bumpers to cushion the load in case of wheel malfunction and avoid risk of contact between wheels

ADAPTABLE

Safely compatible with a wide range of beam widths. H, I, straight, curved or edged

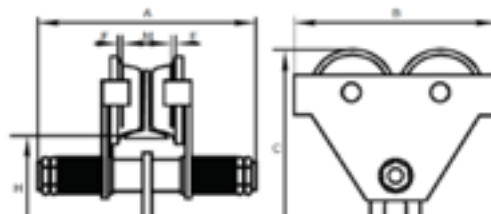

Model	Capacity	Rated capacity (lb)	Beam sole width (in)	minimum bending radius (in)	A	B	C	H	Weight (lb)
CM1000	1 T	2200	2-1/2 to 5-1/2	40	10"	10-3/64"	9-7/64"	5-3/64"	26.50
CM2000	2 T	4400	3 to 6-1/2	48	11-9/16"	11-29/32"	10-15/16"	5-63/64"	48.50

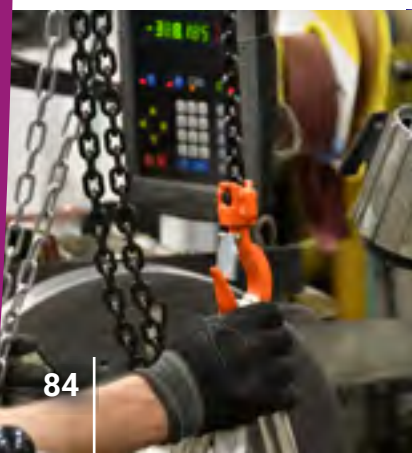

Chain hoists CPC series

*Tested at 150% of rated capacity (certificate included)

Capacity of 1/2T, 1T and 2T

One-year warranty

ASME B30.16 Certified

Nameplate including serial number and capacity

SECURITY

Weston brake system, slow folding of hooks with security latch in case of overload, orange finish

ADAPTABLE

Triple gear, exclusive first-grade asbestos-free disc to improve lifetime, high-quality 80 caliber lifting chain, bearings with armoured seals

Model	PC05010	PC05020	PC10010	PC10020	PC20010	PC20020
Lifting capacity nominal (tons)	1/2	1/2	1	1	2	2
Standard lifting height (ft)	10	20	10	20	10	20
Clearance (in)	11-1/32	11-1/32	12-1/16	12-1/16	17-1/2	17-1/2
Number of chainfalls	1	1	1	1	1	1
Load chain diameter (mm)	6	6	6	6	8	8
Force to lift the rated load (lb)	49	49	68	68	102	102
Hand chain length required to lift a load 1 foot (in)	27	27	40	40	70	70
Product weight (lb)	19.80	30.80	24.20	35.40	38.63	54.69
A	4-15/16"	4-15/16"	5-3/4"	5-3/4"	7-1/4"	7-1/4"
B	4-13/16"	4-13/16"	5-1/2"	5-1/2"	6-1/4"	6-1/4"
C	1-3/8"	1-3/8"	1-3/4"	1-3/4"	2-1/16"	2-1/16"
G	1-1/16"	1-1/16"	1-5/16"	1-5/16"	1-5/16"	1-5/16"
H	11-1/32"	11-1/32"	12-1/16"	12-1/16"	17-1/2"	17-1/2"



Lever hoists CPL series

*Tested at 150% of rated capacity (certificate included)

Capacity of 3/4T and 1-1/2T

One-year warranty

ASME B30.16 Certified

Nameplate including serial number and capacity



SECURITY

Hooks with deformation indicator that allows maintenance, Weston brake system, orange finish

ADAPTABLE

High-quality 80 caliber lifting chain, designed to withstand impacts, cold-stamped steel, exclusive first-grade asbestos-free disc to extend lifetime

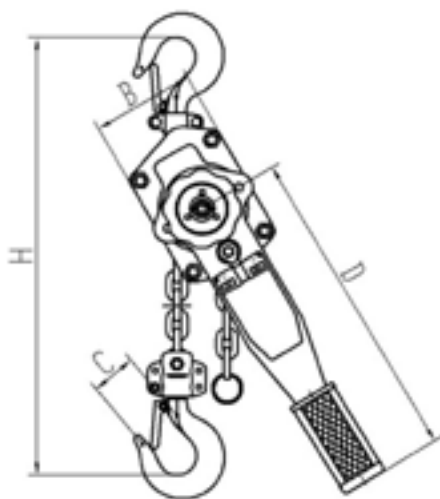

Model	PL07505	PL07510	PL15005	PL15010
Lifting capacity nominal (tons)	3/4	3/4	1-1/2	1-1/2
Standard lifting height (ft)	5	10	5	10
Number of chainfalls	1	1	1	1
Diameter of the loading chain (mm)	6	6	8	8
Force to lift the rated load (lb)	31	31	48	48
Length of the lever (in)	12	12	16-1/2	16-1/2
Minimum distance between brackets (in)	12	12	15	15
Product weight (lb)	13.20	15.40	26.40	28.70
A	5-7/8"	5-7/8"	6-3/4"	6-3/4"
B	3-1/2"	3-1/2"	3-7/8"	3-7/8"
C	1-1/2"	1-1/2"	1-7/8"	1-7/8"
D	12"	12"	16-1/2"	16-1/2"
H	12-3/4"	12-3/4"	15"	15"



General purpose hand truck

Frame : aluminum
Wheels : rubber

Elastic strap to secure load

Part Number	Use	Maximum load
CR7000	general	260 lb



Plate 15-1/4 x 11"



Folding hand truck

Frame : aluminum
Wheels : rubber

Elastic strap to secure the load

Part Number	Use	Maximum load
CR7100	Light duty	175 lb



Plate 16-1/2" x 11-1/2"



Type 3 Webbing Slings - 2 ply

Standards: WSTDA-WS-1 / ASME B30.9

Polyester sling resistant to most chemicals

Non resistant to acids, aldehydes, ethers and strong alkalis

Part Number	Length	Width	Vertical WLL	Chocker WLL	Basket WLL
CR7300	6'	1"	3100 lb	2480 lb	6200 lb
CR7301	8'	1"	3100 lb	2480 lb	6200 lb
CR7302	12'	1"	3100 lb	2480 lb	6200 lb
CR7303	2'	2"	6200 lb	4960 lb	12400 lb
CR7304	4'	2"	6200 lb	4960 lb	12400 lb
CR7305	6'	2"	6200 lb	4960 lb	12400 lb
CR7306	8'	2"	6200 lb	4960 lb	12400 lb
CR7307	10'	2"	6200 lb	4960 lb	12400 lb
CR7308	12'	2"	6200 lb	4960 lb	12400 lb
CR7309	16'	2"	6200 lb	4960 lb	12400 lb
CR7310	20'	2"	6200 lb	4960 lb	12400 lb

WLL = Working Load Limit

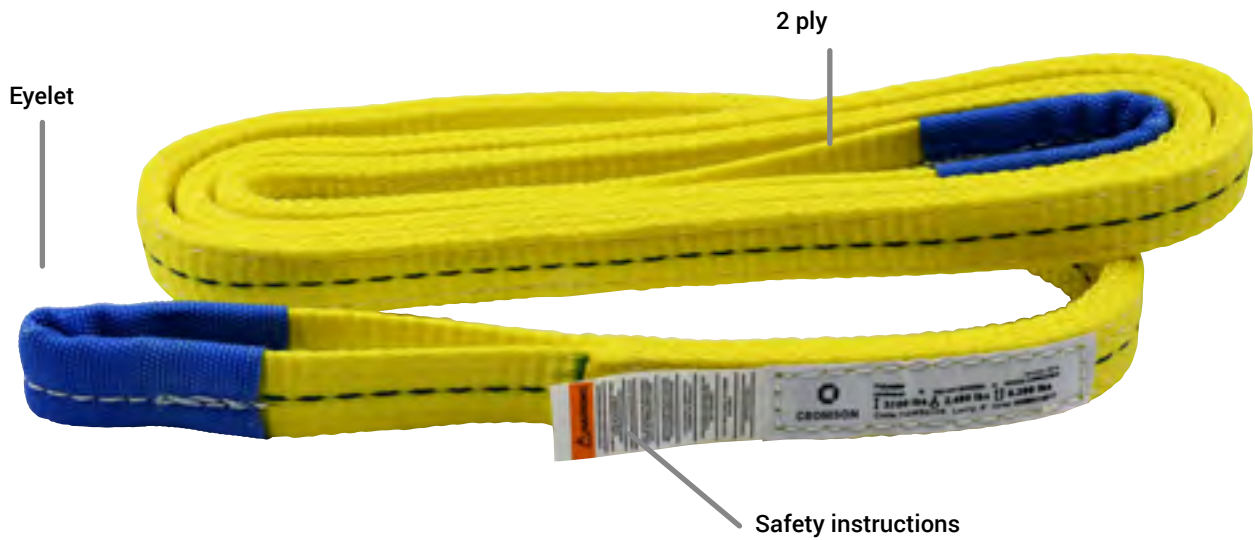



THREE TYPES OF USES

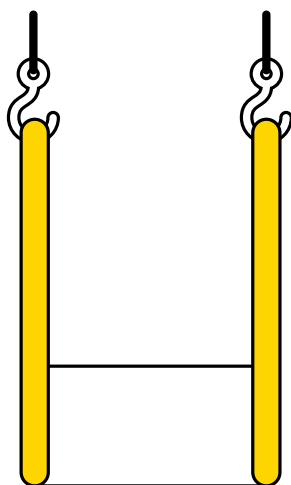

Basket

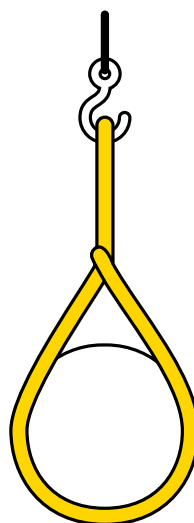

Choker

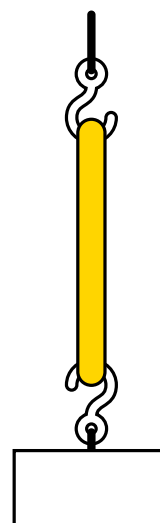

Vertical

Information label of product characteristics

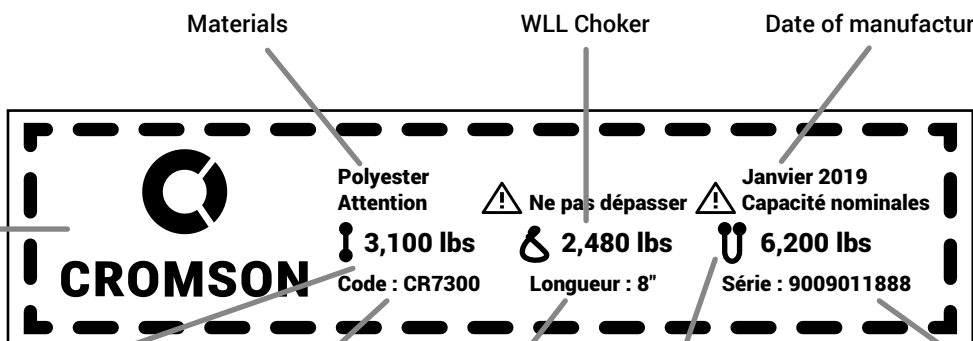

WLL vertical

Part Number

Length

WLL Basket

Serial number

Ratchet straps

Standards: WSRDA-T1
Polyester
Iron (Steel) Buckle
Hook type: Double J



Part Number	Length	Width	Breaking strength	WLL	Weight
CR7370	16'	1"	3 000 lb	1 500 lb	1.72 lb
CR7371	21'	2"	11 000 lb	5 000 lb	4.94 lb

Control hazards to reduce adverse health effects
and limit damage to the facility
It is important to respect procedures!
Whenever you face an emergency, stay calm
and follow the established procedures

EMERGENCY NUMBERS CANADA:

9-1-1

To report a life-threatening emergency

8-1-1

To report a non-life-threatening incident

When calling these numbers, be prepared to provide the following information:

Type of emergency

Address of the emergency

Phone number

Type of required assistance

Treatments previously administered

The above information comes from the official CCHSCT Canada website.
Please refer to the regulations for more information.



SAFETY

ONE MOTTO AND A SINGLE GOAL:
TO MAKE AVAILABLE SIMPLE AND EFFECTIVE SOLUTIONS
TO PREVENT EVERYDAY ACCIDENTS AND TO PROTECT THOSE AROUND YOU



EXPERTISE

Products researched and designed for professional use that meet or exceed industry standards



QUALITY

A wide range of safety products offering the best value for the money



INNOVATION

Adaptable protection to ensure your safety and the safety of others



Vehicle First Aid Kit

QUEBEC CNESST Regulation

1-5 workers
Plastic box

Part Number CR8000



Industrial First Aid Kit

QUEBEC CNESST Regulation

1-50 workers
Plastic box

Part Number CR8001



Quebec Regulation First Aid Kits

Description	Vehicle Kit	Industrial Kit
Alcohol Swabs	5	25
Assorted Safety Pins – 4 large / 4 medium / 4 small	1	1
Compress Bandage - 4" (10 cm)	2	4
First Aid Pocket Guide	1	1
Hospital Tape - 1" x 10VG (2.5 cm x 9.1 m)	1	1
Nickel Plated Forceps – 3.5" (9 cm)		1
Plastic Strips – 1" x 3" (2.5 cm x 7.5 cm)	5	25
Scissor Kit – 4" (10 cm)	1	1
Sterile Gauze Bandage – 2" x 10VG (5 cm x 9.1 cm)	1	4
Sterile Gauze Bandage - 4" x 10VG (10 cm x 9.1 cm)	1	4
Sterile Gauze Pads - 4" x 4" (10 cm x 10 cm)	5	25
Triangular Bandage - 40" (1 m)	2	6

First Aid Kits

ONTARIO SCH Regulation



1-5 workers
Plastic box

Part Number CR8002

6-15 workers
Plastic box

Part Number CR8003

16-200 workers
Plastic box

Part Number CR8004



Ontario Regulation First Aid Kits

Description	1 - 5 WORKERS	6 - 15 WORKERS	16 - 200 WORKERS
Aluminum Splint - 24" (60.96 cm)		1	
Assorted Safety pins – 4 large / 4 medium / 4 small	1	1	2
Compress - 4" (10 cm)	2	4	6
First Aid Pocket Guide	1	1	1
Gauze Bandage – 1" x 5VG (2.5 cm x 4.5 m)			12
Gauze Bandage – 2" x 5VG (5 cm x 4.5 cm)	2	4	8
Gauze Bandage - 4" x 5VG (10 cm x 4.5 cm)		4	8
Gauze Pad - 3" x 3" (7.5 cm x 7.5 cm)	4	12	48
Hospital Tape - 1" x 5VG (2.5 cm x 4.5 m)			2
Plastic Emesis Basin			1
Plastic Strips – 3/4" x 3" (1.9 cm x 7.5 cm)	12	24	48
Splint Padding (1/pack)		2	2
Splint Set (6/pack)			1
Stainless steel Wash Basin			1
Triangular Bandage - 40" (1 m)	1	6	12

Block public access to dangerous areas
Define an obstacle
Define a bypass path

The four fundamental principles



ADAPTATION

- ▲ To public roads, speed and traffic density
- ▲ Type and scope of work

COHERENCE

- ▲ Between road signs and permanent signage
- ▲ Between the information provided by the equipment and that given by the flagman

CREDIBILITY

- ▲ Bypass routes must be justified by the reality and nature of the construction site
- ▲ Messages must be communicated to all drivers

VISIBILITY

- ▲ Signaling devices must be clean, in good condition and properly installed
- ▲ Signage sizes and colours must be in accordance with industry standards

*All information is given as an indication only
Thank you for taking note of the established regulations before using traffic cones
Source: Transports Québec / APSAM - road works signage guide*



Traffic cones

Body is made of durable PVC
Black rubber base

Use in various weather conditions (Temperature Range: -20°C to +50°C)

High visibility safety orange

Thermoformed molding

Stackable

Part Number	Height	Base	Collar	Weight (lb)
CR8100	18" - 450 mm	10-5/8" x 10-5/8"	-	3
CR8101	18" - 450 mm	10-5/8" x 10-5/8"	(1) 4"	3
CR8102	18" - 450 mm	10-5/8" x 10-5/8"	(1) 6"	3
CR8103	28" - 700 mm	14" x 14"	-	7
CR8104	28" - 700 mm	14" x 14"	(1) 4"	7
CR8105	28" - 700 mm	14" x 14"	(1) 4" & (1) 6"	7



* Picture no contractual



DISCOVER OUR NEW RANGE OF HAND PROTECTION



MOHAN HAND PROTECTION

The new Mohan range specializes in hand protection for professional use and offers products that are:

- **Rugged** with high quality materials resistant to chemical products and tears
- **Comfortable** as well as offering greater dexterity
- **Safe** protection for your hands during maintenance operations, handling, production...

This expanding range of product offers:

- Black Nitrile **gloves** 6 mil
- Blue Nitrile **gloves** 8 mil
- Heavy-duty degreaser **wipes**



DID YOU KNOW ?

All white tigers around the world today have the same ancestor: Mohan. He was the first white tiger found in India in 1951. From the Panthera tigris endangered species, we recognize them by their white coat with black or brown stripes. Its scarcity makes it a precious tiger, stronger and bigger than others.

Like the tiger, your hands are precious, and you need to protect them. You won't look at your paws the same way!





Application: maintenance, manufacturing, material handling, food handling, automobile, etc.
 Textured for excellent grip
 Resistant to chemicals and tears
 Store in a cool, dry place
 Avoid excessive heat (40°C, 104°F)

Heavy Black Nitrile Gloves

Nitrile - 6 mil

Approved for food handling by CFIA

Powder-Free and non-sterile

Packaging: 100 gloves

Part Number	Size
CR8200S	S - 85 mm
CR8200M	M - 95 mm
CR8200L	L - 105 mm
CR8200XL	XL - 115 mm
CR8200XXL	XXL - 125 mm



Heavy Blue Nitrile Gloves

Nitrile - 8 mil

Approved for food handling by CFIA

Powder-Free and non-sterile

Packaging: 50 gloves

Part Number	Size
CR8250M	M - 95 mm
CR8250L	L - 105 mm
CR8250XL	XL - 115 mm
CR8250XXL	XXL - 125 mm



CFIA = Canadian Food Inspection Agency

Clean and degreasing impregnated wipes

Tested under dermatological control
In accordance with the Cosmetic Regulations (EU)no 1223/2009
In accordance with Detergent Regulation (EU) n ° 648/2004
Highly efficient cleaning towels for hands, tools and machine parts

Type: Double sided rough / soft
Color: Blue / white
Grammage: 45g / m² - tolerance $\pm 12\%$
pH: 5.0 ± 0.5
Density: 1.00 ± 0.05

Perfume: Citrus
Storage temperature: $5^{\circ}\text{C} < T < 40^{\circ}\text{C}$

40 per box



Effective cleaning of hands, surfaces, tools, machines and objects

Can be used without water, without soap, without rinsing and residue-free

Convenient packaging, ready to use

Non irritating formula

Biodegradable



Double-faced wipes:

- textured blue side - gentle abrasive very effective for heavy stains
- smooth white side - soft for finishing cleaning

Part Number

CR2830

1/2" drive extensions	p. 17
1/2" drive ratchet	p. 17
1/2" drive sockets	p. 18
1/2" drive sockets deep	p. 19
1/2" drive universal joint	p. 17
1/4" drive bit-holder screwdriver	p. 11
1/4" drive bit-holder socket	p. 11
1/4" drive extensions	p. 9
1/4" drive ratchet	p. 9
1/4" drive sockets	p. 10
1/4" drive universal joint	p. 9
3/8" drive extensions	p. 13
3/8" drive ratchet	p. 13
3/8" drive sockets	p. 14
3/8" drive sockets deep	p. 15
3/8" drive universal joint	p. 13
Abrasive rolls	p. 57
Abrasive rolls dispenser	p. 57
Adjustable wrenches	p. 26
Bars	p. 74
Cable ties	p. 73
Carbide burrs	p. 65
Chain hoists	p. 85
Clamps	p. 30
Cleaning wipes	p. 99
Coating removal discs	p. 53 - 55
Countersinks	p. 60
Cut-off wheels	p. 56
Cutting wheels	p. 51
Disc holders	p. 55
Drill bits HSS	p. 66 - 67
Drill bit sets HSS	68
First aid kits	p. 92 - 93
Flap discs	p. 52

Flashlights	p. 73
Folding table	p. 29 & 81
Gloves	p. 98
Grinding discs	p. 52
Grinding wheels	p. 53
Hammers	p. 31
Hand tool sets	p. 44 - 45 - 46 - 47
Hand trucks	p. 84
Hex key sets	p. 26
Knives and blades	p. 78 - 79
Lever hoists	p. 86
Measuring tapes	p. 40
Paint brushes	p. 72
Pliers	p. 34 - 35
Pliers locking	p. 37 - 38 - 39
Quick support rods	p. 30
Ratchet straps	p. 89
Screwdriver set	p. 20
Screwdrivers	p. 22 - 23
Screwdriver bit set	p. 11
Shovels	p. 75 - 76 - 77
Slings	p. 88
Step drills	p. 65
Storage boxes	p. 45 - 47
Surface conditioning Discs	p. 54
Taps HSS	p. 62 - 63 - 64
Tap sets HSS	p. 61
Tarps	p. 72
Traffic cones	p. 95
Trolleys	p. 87
Vises and jaws	p. 28 - 29 - 64
Wrenches and sets	p. 24 - 25
Wrench pouch	p. 25

[illegible]



CROMSON

Expertise • Quality • Innovation



CROMSON is a passionate and devoted team with heart and commitment.

1

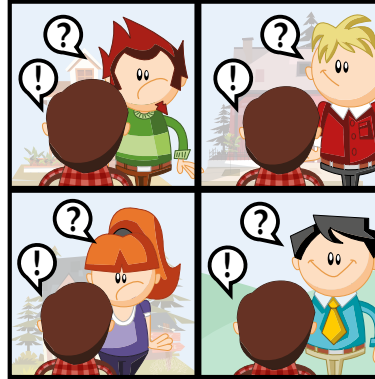

Openly receptive, motivated and versatile, they can adapt to anything the client wants.

2

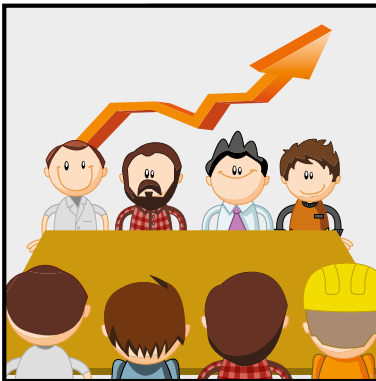

2013
The results speak for themselves, the market study shows there is a real demand. A new brand is created!

3



2016
Time for the launch! CROMSON, a robust and solid brand, is launched on the market. Its slogan: "Expertise, Quality, Innovation".

4

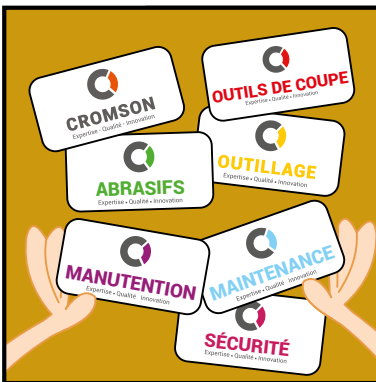

The brand grows and now offers different types of products: Cutting tools, Hand tools, Abrasives, Safety, Material Handling, Maintenance...

5

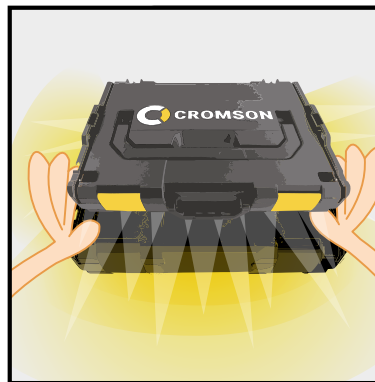

To ensure a high-end product, CROMSON forms partnerships with the largest manufacturers in North America and Europe.

6

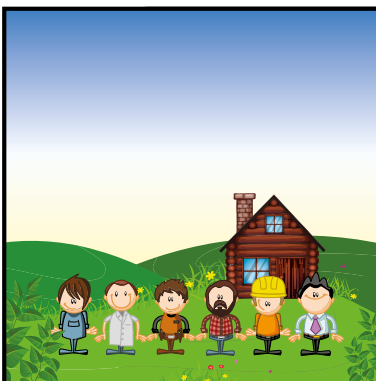

Only 6 years old, this brand benefits from over 200 years of cumulated experience in industrial supply.

7



The brand is in constant evolution and continues to grow because of its partners and collaborators. The CROMSON team stays tuned to new developments in order to always offer the best it possibly can to its clients.

8



CROMSON

Expertise - Quality - Innovation

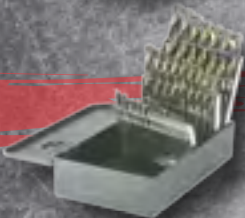
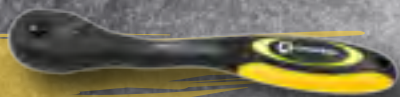

A brand distributed exclusively by
the companies of the group:

 **FICODIS**



Your local distributor:

CROMSON
1001-465, Saint-Jean,
Montreal, Quebec
H2Y 2R6, CANADA

cromson.com